

SERIE
ST

2024_LINE_1

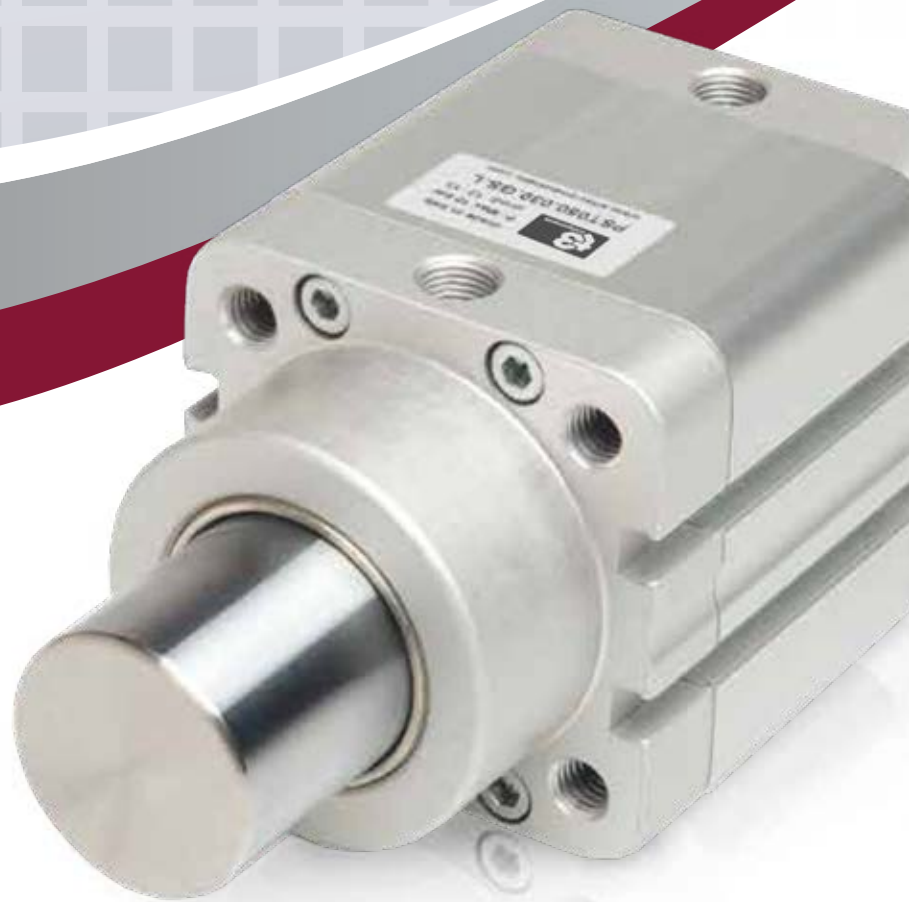

Cilindri stopper
Stopper Cylinders



CARATTERISTICHE TECNICHE - TECHNICAL CHARACTERISTICS

Pressione di esercizio <i>Working pressure</i>	2 ÷ 10 bar (semplice effetto - <i>single acting</i>)
Temperatura di esercizio <i>Working temperature</i>	0 ÷ +80 °C (-20 °C con aria secca - <i>with dry air</i>)
Versioni - Versions	semplice effetto molla posteriore - <i>single acting rear spring</i> doppio effetto molla posteriore - <i>double acting rear spring</i> doppio effetto - <i>double acting</i>
Alesaggi - Bores	∅ 20 - 32 - 50 - 80
Corse - Strokes	15 - 20 - 30
Fluido - Fluid	aria compressa filtrata, non lubrificata - <i>compressed filtered, non lubricated air</i>

CARATTERISTICHE COSTRUTTIVE - CONSTRUCTIVE CHARACTERISTICS

①	Stelo - Rod	acciaio inox cromato - <i>chromed stainless steel</i>
②	Boccola - Bush	acciaio+PTFE - <i>steel+PTFE</i>
③ ⑪	Testate - Covers	alluminio anodizzato - <i>anodized aluminium</i>
④ ⑧	Guarnizioni - Seals	poliuretano - <i>polyurethane</i>
⑤	O-ring	NBR
⑥	Pistone - Piston	alluminio - <i>aluminium</i>
⑦	Magnete - Magnet	plastoferrite - <i>rubber magnet</i>
⑨	Tubo - Tube	alluminio anodizzato - <i>anodized aluminium</i>
⑩	Molla - Spring	acciaio - <i>steel</i>
	Viti - Screws	acciaio zincato - <i>zinc coated steel</i>
	Paracolpo - Bumper	poliuretano - <i>polyurethane</i>

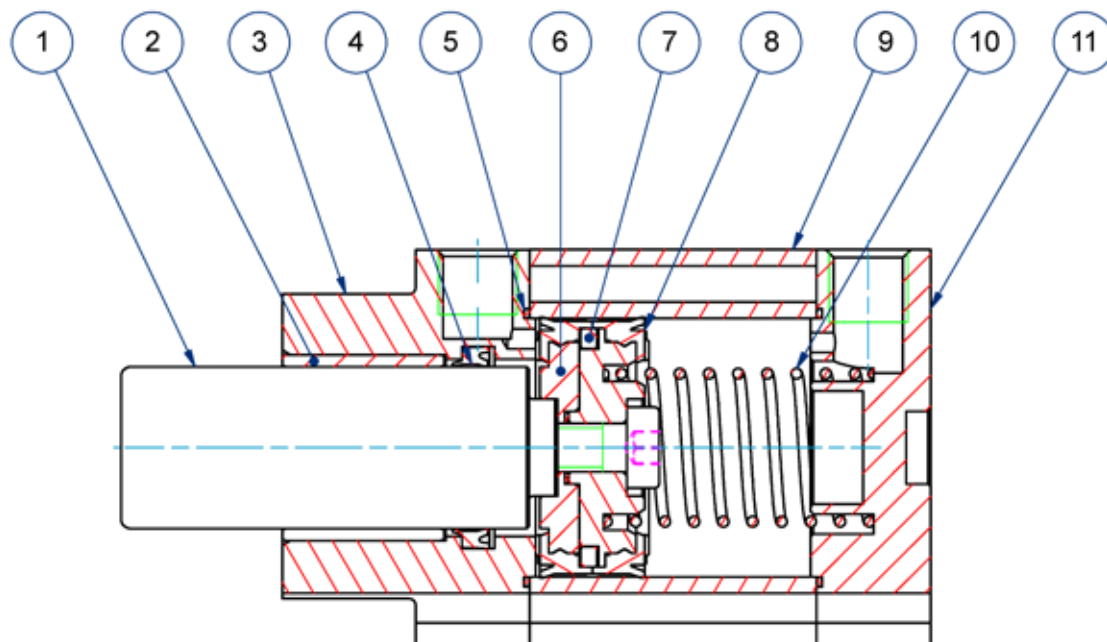

CHIAVE DI CODIFICA

KEY CODE

P S T		0 5 0 . 0 3 0 . G S . L				
		ALESAGGIO - BORE (Ø)		CORSA - STROKE (mm)		OPZIONE - OPTION
		020		015		EX ATEX CE II 2GD c T4
		032		020		
		050-080		030		
		SERIE - SERIES				
		semplice effetto molla posteriore single acting rear spring				
		D doppio effetto con molla posteriore double acting with rear spring				
		D1 doppio effetto senza molla double acting without spring				
		VERSIONE - VERSION				
		ST STOPPER semplice effetto magnetico single acting magnetic STOPPER				
		SERIE - SERIES				
ISO 21287	P	tubo profilato con cave per sensori tube with slots for sensors				
UNITOP	A	tubo profilato con cave per sensori tube with slots for sensors				
		STELO - ROD				
		L liscio smooth				
		F femmina female				
		R con rullino with roller				
		GUARNIZIONI - SEALS				
		GS guarnizioni standard standard seals				

SERIE
ST

ESECUZIONI A RICHIESTA - ON REQUEST

Stelo prolungato (WH) - *Extended rod (WH)*

Filetti speciali (dado stelo non fornito) - *Special thread (without rod nut)*

ATEX CE II 2GD c T4

FORZA TEORICHE DI TRAZIONE (P=6bar)

THEORETICAL FORCES OF TRACTION (P=6bar)

		Ø	020	032	050	080	
AST	PST	SPINTA - THRUST	[N]	188	482	1178	3014
		TRAZIONE - TRACTION	[N]	120	294	695	1837

SCHEMA DI FUNZIONAMENTO

DIAGRAM OF OPERATION

STELO LISCIO - SMOOTH ROD

SERIE
ST

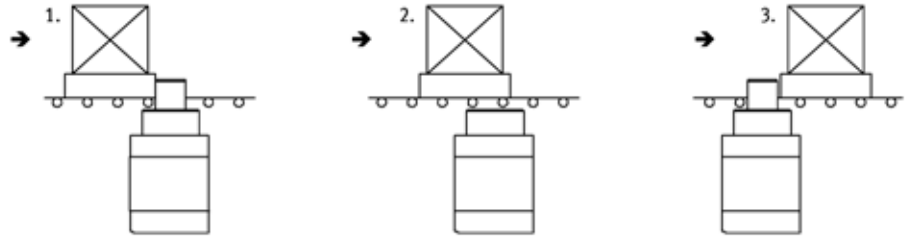

STELO CON RULLINO - ROD WITH ROLLER



DIAGRAMMA CARICO AMMISSIBILE

ALLOWABLE LOAD

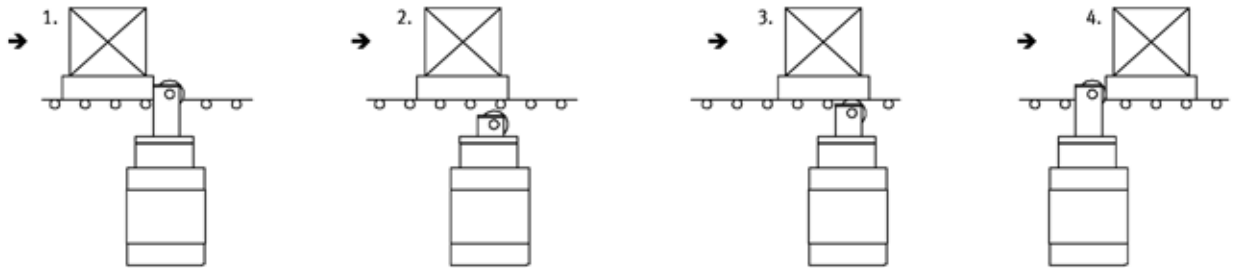
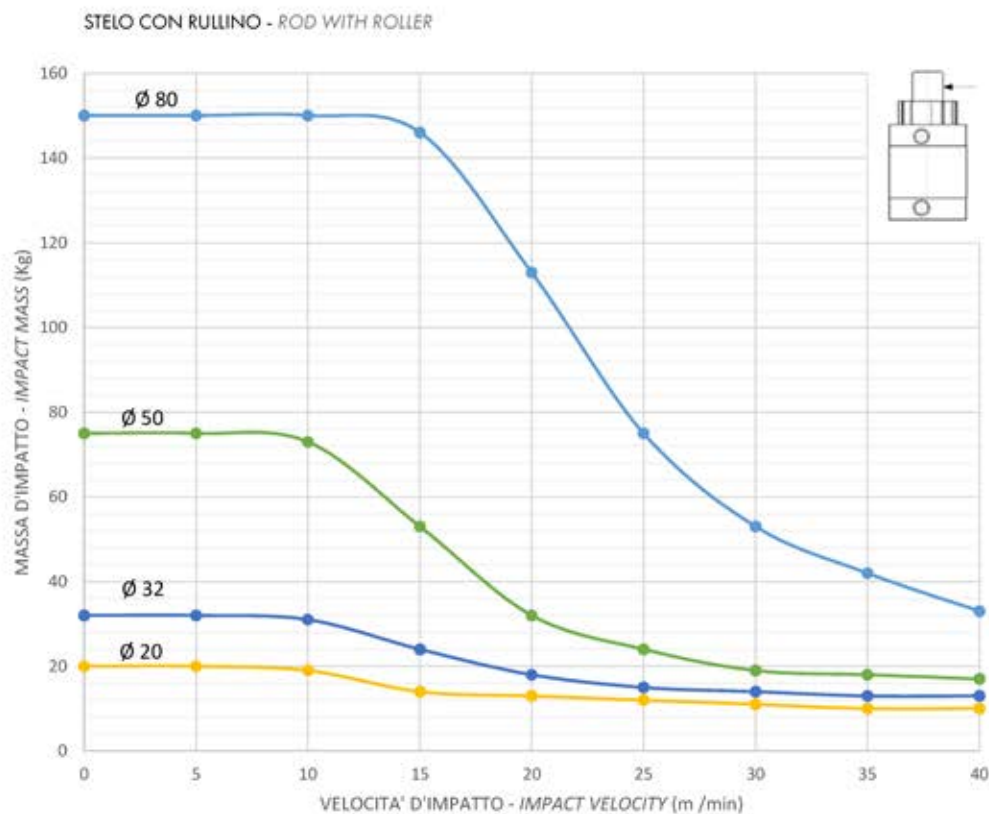
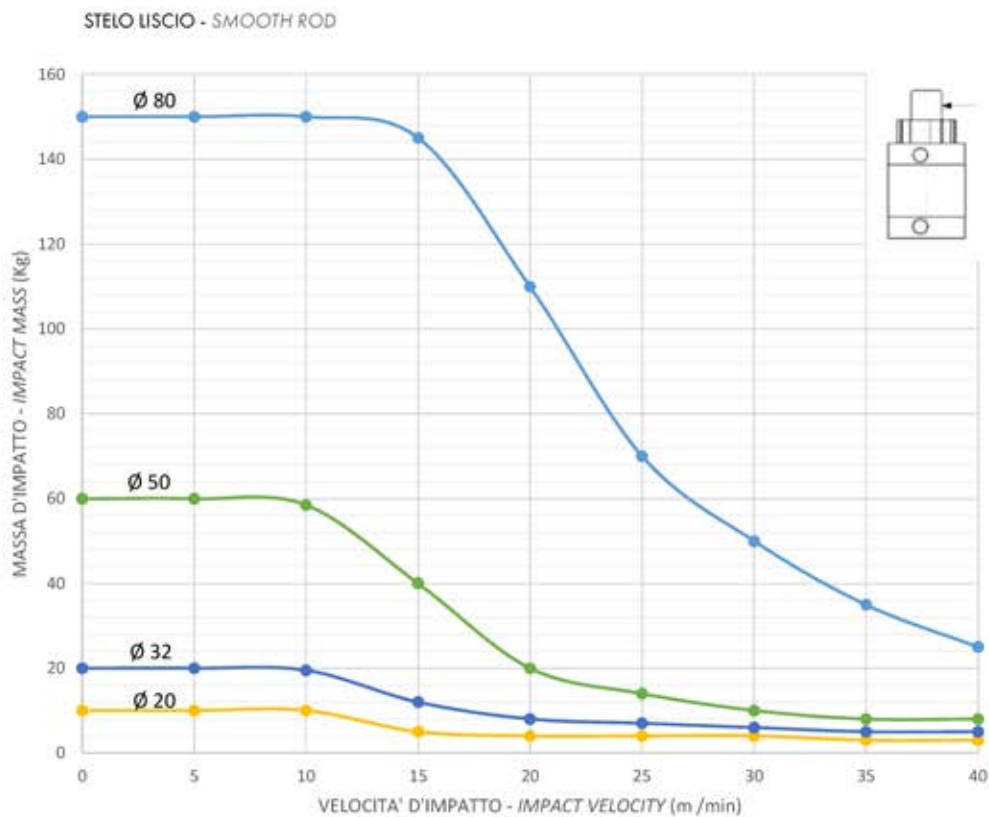

SERIE
ST

CILINDRO STOPPER

STC

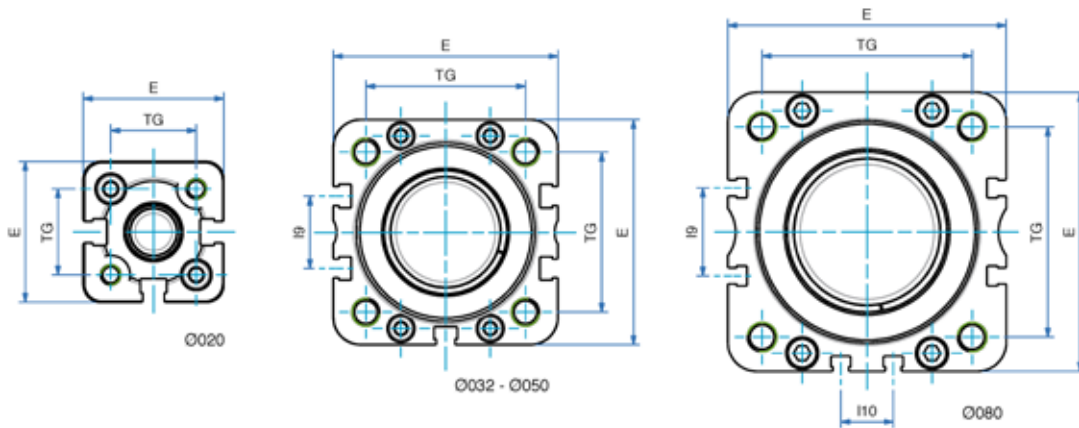

SERIE
ST

SEMPLICE EFFETTO MOLLA POSTERIORE

PST

DOPPIO EFFETTO MOLLA POSTERIORE

PSTD

SINGLE ACTING REAR SPRING

DOUBLE ACTING REAR SPRING

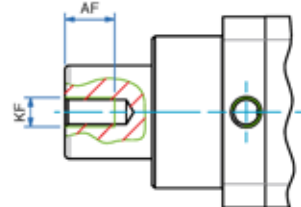
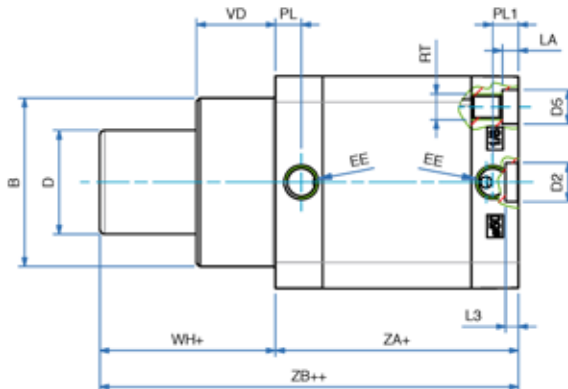
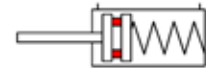
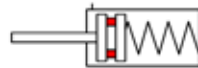

DOPPIO EFFETTO SENZA MOLLA

PSTD1

DOUBLE ACTING WITHOUT SPRING

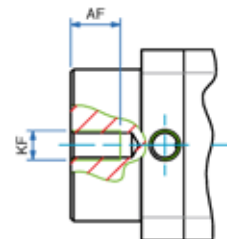
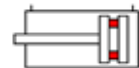
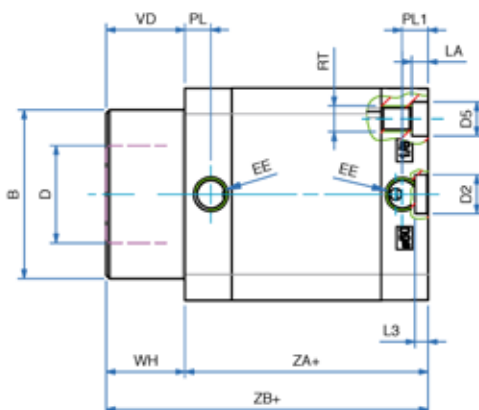

CILINDRI STOPPER
STOPPER CYLINDERS

DIMENSIONI - DIMENSIONS				
Ø	020	032	050	080
AF	15	15	17	20
Ø B	26	38	52	76
Ø D	12	20	32	50
Ø D2	9	9	12	12
Ø D5	7,5	9	10,5	13,5
E	36	49	65,5	95,5
EE	M5	G1/8"	G1/8"	G1/8"
I9	-	10,8	21	30
I10	-	-	-	18
KF	M6	M8	M10	M12
LA	4,5	5	5	3
L3	3	3	4	4
PL	9	8	8	8
PL1	7,5	8	8	8
RT	M5	M6	M8	M10
TG	22	32,5	46,5	72
VD	11,5	16,5	24,5	15
WH	11,5	16,5	24,5	15
WH+	11,5	16,5	24,5	15
ZA+	38	44	45	96
ZB+	49,5	60,5	69,5	111
ZB++	49,5	60,5	69,5	111

Ø	CORSE STANDARD - STANDARD STROKES
020	15
032	20
050	30
080	30

CILINDRO STOPPER

STOPPER CYLINDER

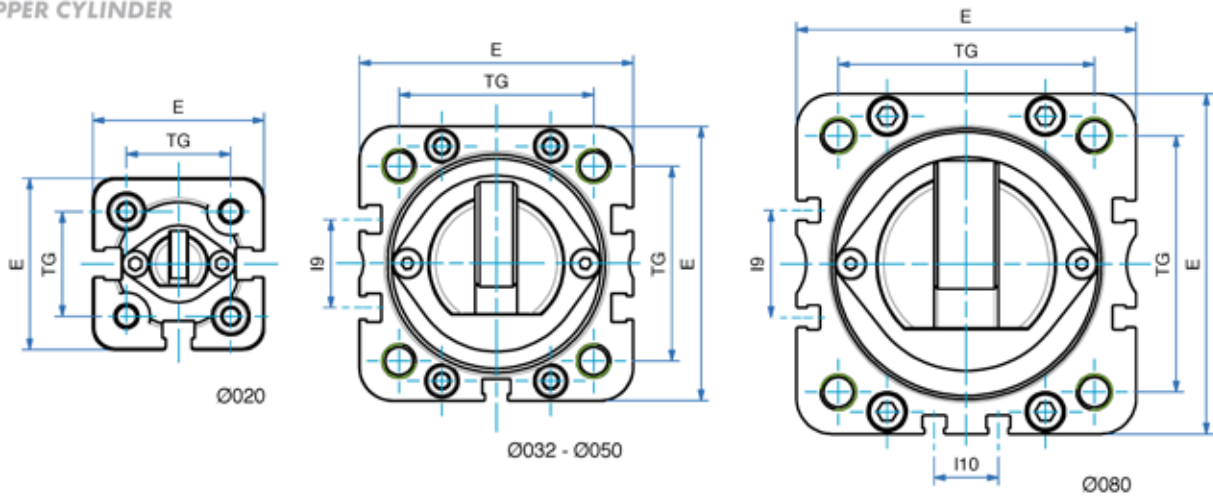
 SERIE
ST
S.E. MOLLA POSTERIORE CON RULLINO
PST-R

SINGLE ACTING REAR SPRING WITH ROLLER

D.E. MOLLA POSTERIORE CON RULLINO
PSTD-R

DOUBLE ACTING REAR SPRING WITH ROLLER

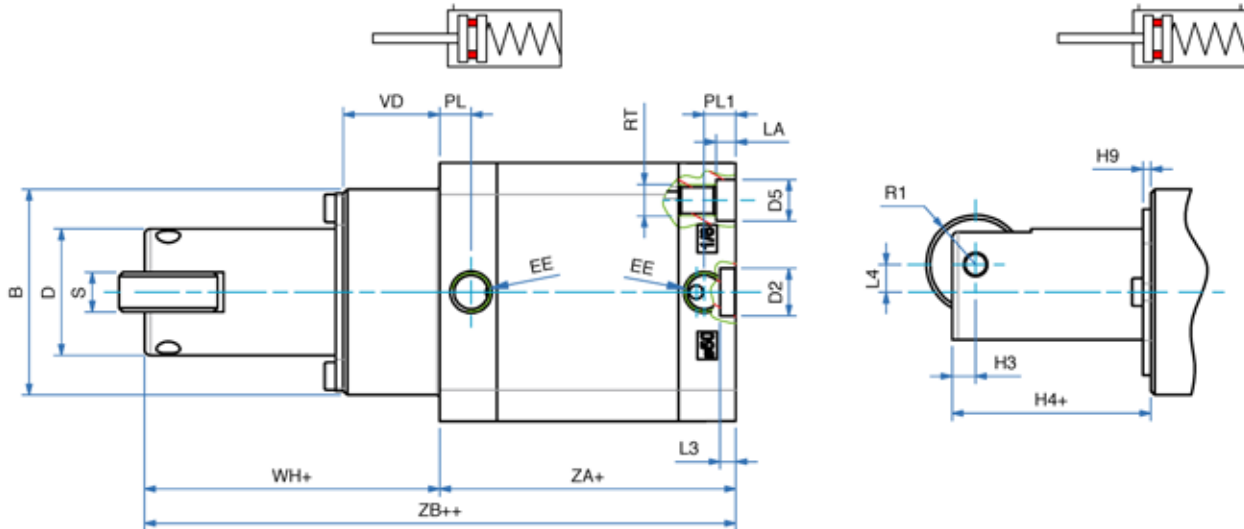
DOPPIO EFFETTO SENZA MOLLA CON RULLINO
PSTD1-R

DOUBLE ACTING WITHOUT SPRING WITH ROLLER

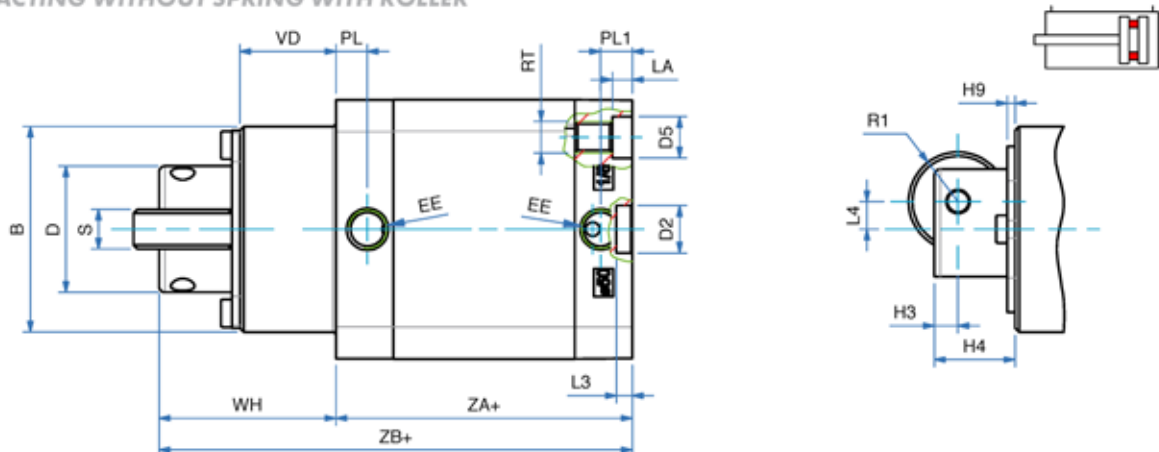

CILINDRI STOPPER
STOPPER CYLINDERS
DIMENSIONI - DIMENSIONS

Ø	020	032	050	080
Ø B	26	38	52	76
Ø D	12	20	32	50
Ø D2	9	9	12	12
Ø D5	7,5	9	10,5	13,5
E	36	49	65,5	95,5
EE	M5	G1/8*	G1/8*	G1/8*
H3	3	6	6	10
H4	9	18	20,5	33
H4+	9	18	20,5	33
H9	2	2	2	3
I10	-	-	-	18
I9	-	10,8	21	30
L3	3	3	4	4
L4	2	3,5	7	11
LA	4,5	5	5	3
PL	9	8	8	8
PL1	7,5	8	8	8
R1	5	9	12,5	18
RT	M5	M6	M8	M10
S	4	8	10	18
TG	22	32,5	46,5	72
VD	11,5	16,5	24,5	15
WH	20,5	34,5	45	48
WH+	20,5	34,5	45	48
ZA+	38	44	45	96
ZB+	58,5	78,5	90	144
ZB++	58,5	78,5	90	144

Ø CORSE STANDARD - STANDARD STROKES

020	15
032	20
050	30
080	30

CILINDRO STOPPER

STOPPER CYLINDER

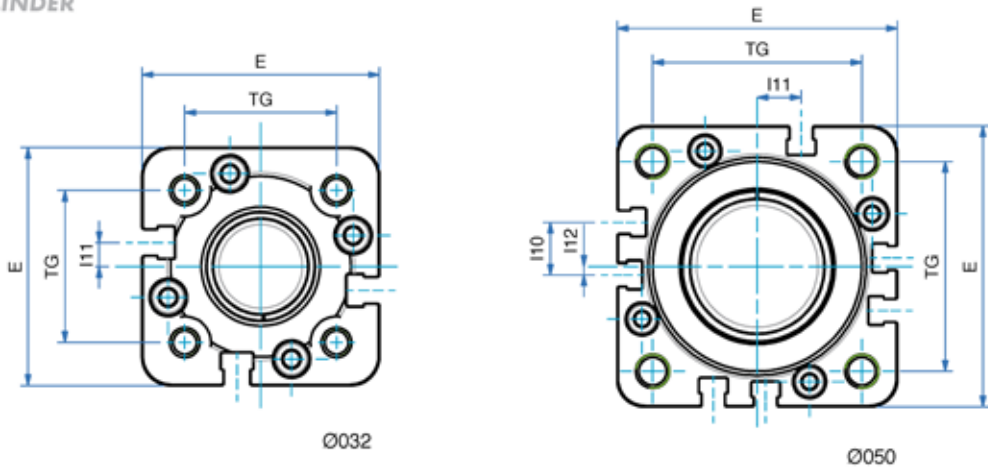
 SERIE
ST
SEMPLICE EFFETTO MOLLA POSTERIORE
AST

SINGLE ACTING REAR SPRING

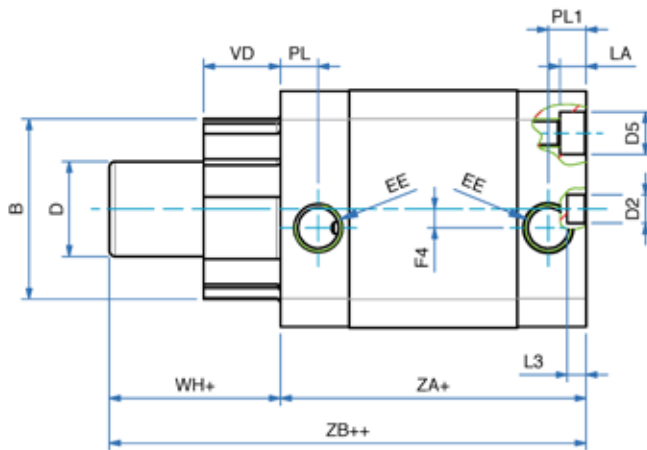
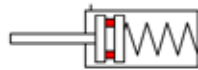
DOPPIO EFFETTO MOLLA POSTERIORE
ASTD

DOUBLE ACTING REAR SPRING

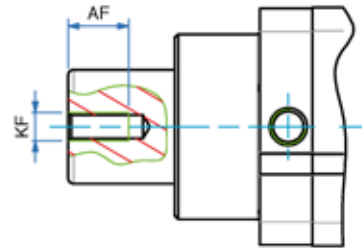
DOPPIO EFFETTO SENZA MOLLA
ASTD1

DOUBLE ACTING WITHOUT SPRING

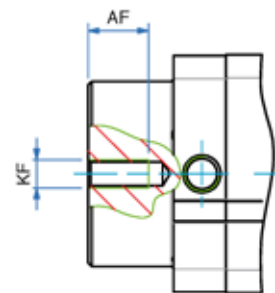
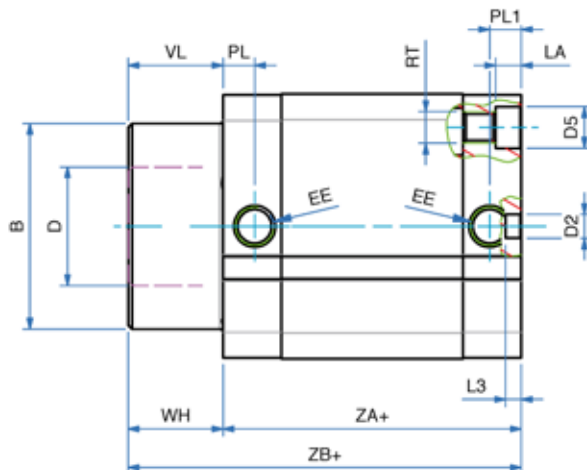

CILINDRI STOPPER
STOPPER CYLINDERS
DIMENSIONI - DIMENSIONS

Ø	032	050
AF	15	17
Ø B	38	52
Ø D	20	32
Ø D2	6	6
Ø D5	9	10,5
E	50	67
EE	G1/8"	G1/8"
F4	4	-
I10	-	12,5
I11	5	10,5
I12	-	2
KF	M6	M8
LA	5,5	6,5
L3	4	4
PL	8	8
PL1	8	8
RT	M6	M8
TG	32	50
VD	16	24
WH	16	24
WH+	16	24
ZA+	44,5	45,5
ZB+	60,5	69,5
ZB++	60,5	69,5

Ø CORSE STANDARD - STANDARD STROKES

032	20
050	30

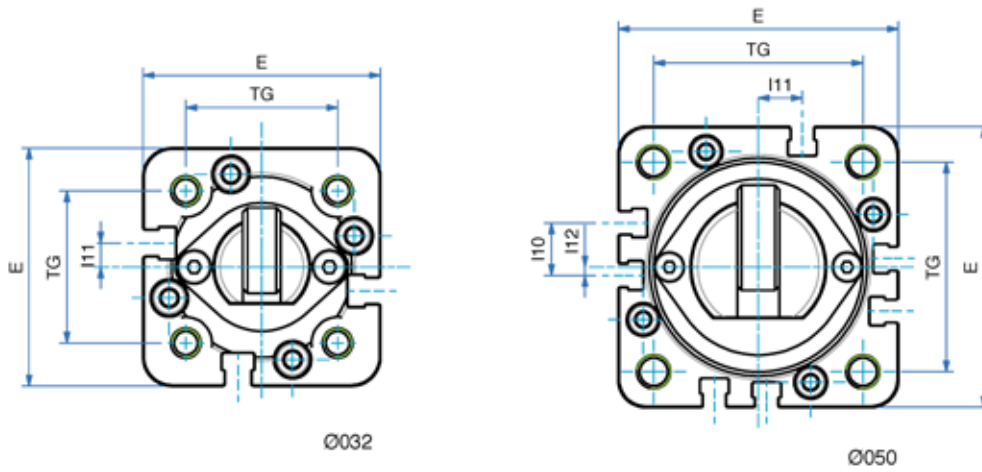

S. E. MOLLA POSTERIORE CON RULLINO

AST-R

D. E. MOLLA POSTERIORE CON RULLINO

ASTD-R

SINGLE ACTING REAR SPRING WITH ROLLER

DOUBLE ACTING REAR SPRING WITH ROLLER

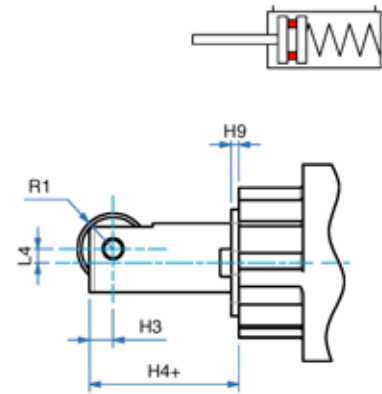
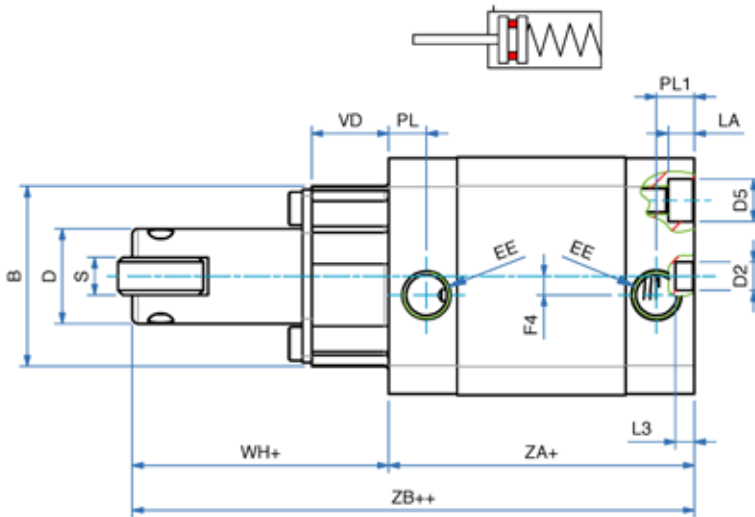

DOPPIO EFFETTO SENZA MOLLA CON RULLINO

ASTD1-R

DOUBLE ACTING WITHOUT SPRING WITH ROLLER

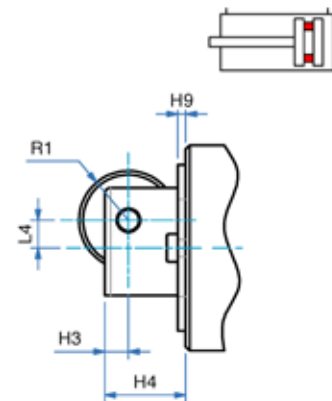
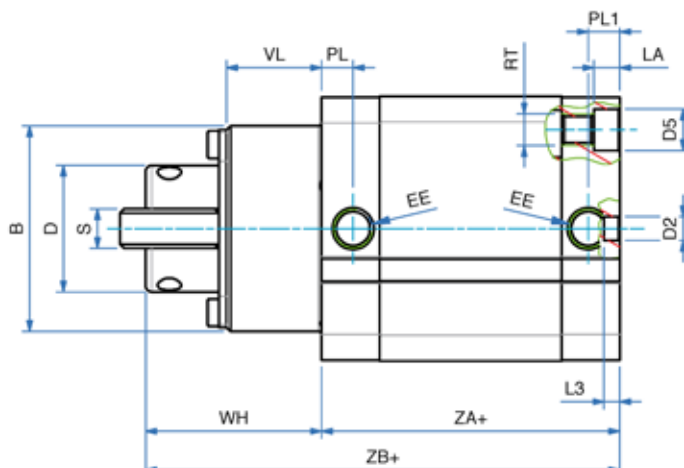

CILINDRI STOPPER
STOPPER CYLINDERS
DIMENSIONI - DIMENSIONS

Ø	032	050
Ø B	38	52
Ø D	20	32
Ø D2	6	6
Ø D5	9	10,5
E	50	67
EE	G1/8"	G1/8"
F4	4	-
H3	6	6
H4	18	20,5
H4+	18	20,5
H9	2	2
I10	-	12,5
I11	5	10,5
I12	-	2
L3	4	4
L4	3,5	7
LA	5,5	6,5
PL	8	8
PL1	8	8
R1	9	12,5
RT	M6	M8
S	8	10
TG	32	50
VD	16	24
WH	34	44,5
WH+	34	44,5
ZA+	44,5	45,5
ZB+	78,5	90
ZB++	78,5	90

Ø CORSE STANDARD - STANDARD STROKES

032	20
050	30



Realized and distributed by
Triveneta automazioni s.r.l.
via Carlo Rosselli, 36 - 36061 Bassano del Grappa (VI)
tel. 0424/505152 - fax 0424/505189

www.triveneta.it - www.t3components.com
amministrazione@triveneta.it
sales.manager@triveneta.it
info@t3components.com





TRIVENETA AUTOMAZIONI s.r.l.

Tel. 0424 505152 - Fax 0424 505189

info@t3components.com

www.t3components.com