

CILINDRI ISO 15552 INOX Ø32-125 ISO 15552 STAINLESS STEEL CYLINDERS Ø32-125



Cilindri costruiti a norma ISO 15552 in versione interamente inox. Caratterizzato dal design pulito e da grande resistenza e precisione di montaggio.

Disponibili in versione magnetica o non, con o senza ammortizzo regolabile, a stelo singolo o passante.

Amplia gamma di accessori.

Su richiesta sono fornibili in varie esecuzioni speciali ed in versione conforme alla direttiva 2014/34/UE ATEX.

ISO 15552 cylinders, stainless steel version.

Featuring a clean design, high resistance and mounting precision. Available with or without magnet, with or without adjustable cushioning, single or through piston rod.

Wide range of mounting accessories. Special versions are available. On request compliant with 2014/34/UE ATEX directive.

VERSIONE VERSION

CDE		CDEP	
CDEM		CDEMP	
CDEA		CDEAP	
CDEMA		CDEMAP	

Su richiesta disponibile in acciaio AISI316
AISI316 stainless steel available on request

INFORMAZIONI TECNICHE TECHNICAL INFORMATION

Testate Covers	Acciaio inox AISI304/AISI316 AISI304/AISI316 Stainless steel
Tubo Tube	Acciaio inox AISI304/AISI316 AISI304/AISI316 Stainless steel
Guarnizioni Seals	Poliuretano - NBR Polyurethane - NBR
Boccola guida Guiding bush	Bronzo sinterizzato Sintered bronze
Stelo Piston rod	Acciaio inox AISI316 AISI316 Stainless steel
Tiranti Tie rods	Ø32-Ø100 acciaio inox AISI316 Ø125 acciaio inox AISI304/AISI316 Ø32-Ø100 AISI316 stainless steel Ø125 AISI304/AISI316 stainless steel
Pressione MAX MAX pressure	10 bar
Temperatura di impiego Working temperature	-20°C +80°C con aria secca -20°C +80°C with dry air
Fluido Working fluid	Aria compressa filtrata e lubrificata e non Filtered and lubricated or not compressed air

CHIAVI DI CODIFICA CYLINDERS KEY CODE

Versione Version		Diametro Diameter	Corsa Stroke	Tipo costruttivo Design Type	Guarnizioni Seals
CDEM		32	100	XF	V
CDE	Doppio effetto non magnetico Double acting non magnetic	32	0...2700	XF ISO 15552 acciaio inox AISI304 ISO 15552 AISI304 stainless steel	- Standard
CDEM	Doppio effetto magnetico Double acting magnetic	40		XY ISO 15552 acciaio inox AISI316 ISO 15552 AISI316 stainless steel	V Guarnizioni FKM FKM seals
CDEA	Doppio effetto con ammortizzo regolabile non magnetico Double acting with adjustable cushioning non magnetic	50			VG Guarnizione stelo FKM FKM rod seal
CDEMA	Doppio effetto con ammortizzo regolabile magnetico Double acting with adjustable cushioning magnetic	63			
CDEP	Doppio effetto stelo passante non magnetico Double acting through rod non magnetic	80			
CDEMP	Doppio effetto stelo passante magnetico Double acting through rod magnetic	100			
CDEAP	Doppio effetto stelo passante con ammortizzo regolabile non magnetico Double acting through rod with adjustable cushioning non magnetic	125			
CDEMAP	Doppio effetto stelo passante con ammortizzo regolabile magnetico Double acting through rod with adjustable cushioning magnetic				



CORSE STANDARD STANDARD STROKES

Ø (mm)	Corse standard (mm) Standard strokes (mm)													
32	10	25	40	50	80	100	125	160	200	250	300	320	400	500
40	10	25	40	50	80	100	125	160	200	250	300	320	400	500
50	10	25	40	50	80	100	125	160	200	250	300	320	400	500
63	10	25	40	50	80	100	125	160	200	250	300	320	400	500
80	10	25	40	50	80	100	125	160	200	250	300	320	400	500
100	10	25	40	50	80	100	125	160	200	250	300	320	400	500
125	10	25	40	50	80	100	125	160	200	250	300	320	400	500

FORZE TEORICHE A 6 BAR THEORETICAL FORCES AT 6 BAR

Ø (mm)	Forza di spinta (N) Thrust force (N)	Forza di trazione (N) Traction force (N)
32	482	414
40	754	633
50	1178	989
63	1869	1681
80	3014	2720
100	4710	4416
125	7359	6877

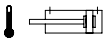
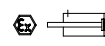
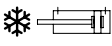
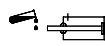
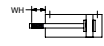
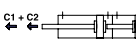
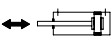
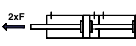
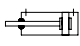
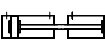
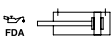
VARIANTI VARIANTS

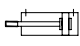
Simbolo Symbol	Caratteristiche Features	Simbolo Symbol	Caratteristiche Features
	Resistente alle alte temperature -10...+150°C Heat-resistant -10...+150°C		Certificazione ATEX ATEX certification
	Resistente alle basse temperature -40...+80°C Low temperature resistant -40...+80°C		Guarnizione stelo ad elevata resistenza chimica Rod seal with increased chemical resistance
	Stelo prolungato Piston rod extension		Configurazione tandem a più posizioni Multi position configuration
	Basso attrito Low friction		Configurazione tandem a doppia spinta Double thrust tandem configuration
	Raschia stelo duro in poliestere Hard wiper in polyester		Configurazione tandem contrapposti anteriore Front opposed tandem configuration
	Lubrificazione FDA FDA lubrication		Configurazione tandem contrapposti posteriore Rear opposed tandem configuration
	Filettature e steli su richiesta Custom made thread or piston rod		

CILINDRI ISO 15552 INOX Ø32-125 ISO 15552 STAINLESS STEEL CYLINDERS Ø32-125

DOPPIO EFFETTO
DOUBLE ACTING

CDEØ/...XF

CDEMØ/...XF

CDEAØ/...XF

CDEMAØ/...XF

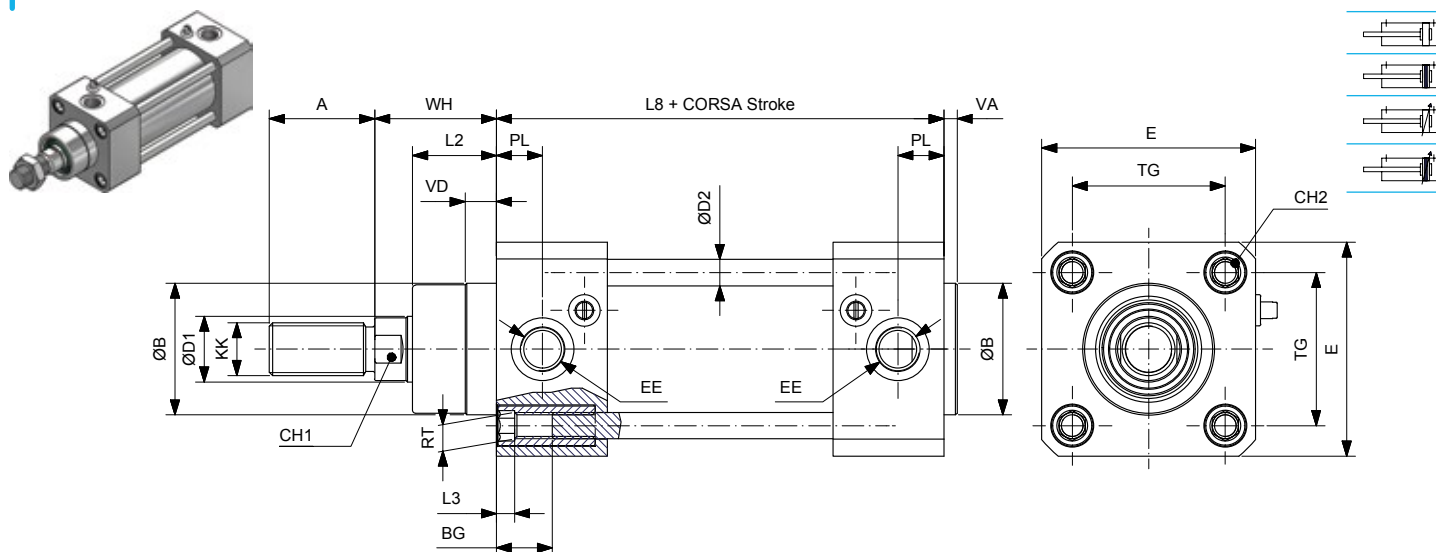

Ømm	ØD1	ØD2	KK	A	ØB	VD	VA	L2	RT	BG	L3	TG	EE	PL	WH	L8	E	CH1	CH2
32	12	6	M10x1.25	22	30	9.5	4	18	M6	16.5	5	32.5	1/8"G	13	26	94	50	10	6
40	16	6	M12x1.25	24	35	9.5	4	22	M6	16.5	5	38	1/4"G	14	30	105	55	13	6
50	20	8	M16x1.5	32	40	9.5	4	25.5	M8	17.5	5	46.5	1/4"G	14	37	106	65	17	8
63	20	8	M16x1.5	32	45	9.5	4	25	M8	17.5	5	56.5	3/8"G	16	37	121	75	17	8
80	25	10	M20x1.5	40	45	10	4	35	M10	17.5	-	72	3/8"G	17	46	128	95	22	-
100	25	10	M20x1.5	40	55	10	4	38	M10	17.5	-	89	1/2"G	18	51	138	110	22	-
125	32	12	M27x2	54	60	11	6	46	M12	20.5	-	110	1/2"G	18	65	160	140	27	-

DOPPIO EFFETTO PASSANTE
DOUBLE ACTING THROUGH PISTON ROD

CDEPØ/...XF

CDEMPØ/...XF

CDEAPØ/...XF

CDEMAPØ/...XF

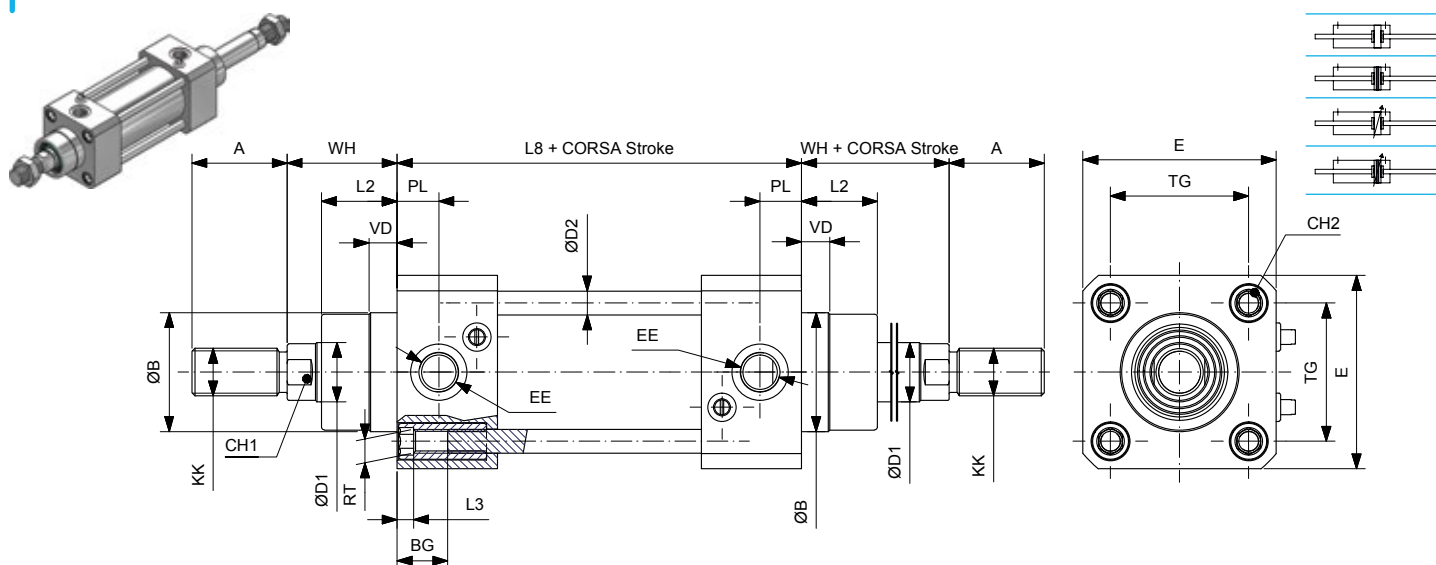

Ømm	ØD1	ØD2	KK	A	ØB	VD	L2	RT	BG	L3	TG	EE	PL	WH	L8	E	CH1	CH2
32	12	6	M10x1.25	22	30	9.5	18	M6	16.5	5	32.5	1/8"G	13	26	94	50	10	6
40	16	6	M12x1.25	24	35	9.5	22	M6	16.5	5	38	1/4"G	14	30	105	55	13	6
50	20	8	M16x1.5	32	40	9.5	25.5	M8	17.5	5	46.5	1/4"G	14	37	106	65	17	8
63	20	8	M16x1.5	32	45	9.5	25	M8	17.5	5	56.5	3/8"G	16	37	121	75	17	8
80	25	10	M20x1.5	40	45	10	35	M10	17.5	-	72	3/8"G	17	46	128	95	22	-
100	25	10	M20x1.5	40	55	10	38	M10	17.5	-	89	1/2"G	18	51	138	110	22	-
125	32	12	M27x2	54	60	11	46	M12	20.5	-	110	1/2"G	18	65	160	140	27	-

ACCESSORI DI FISSAGGIO MOUNTING ACCESSORIES

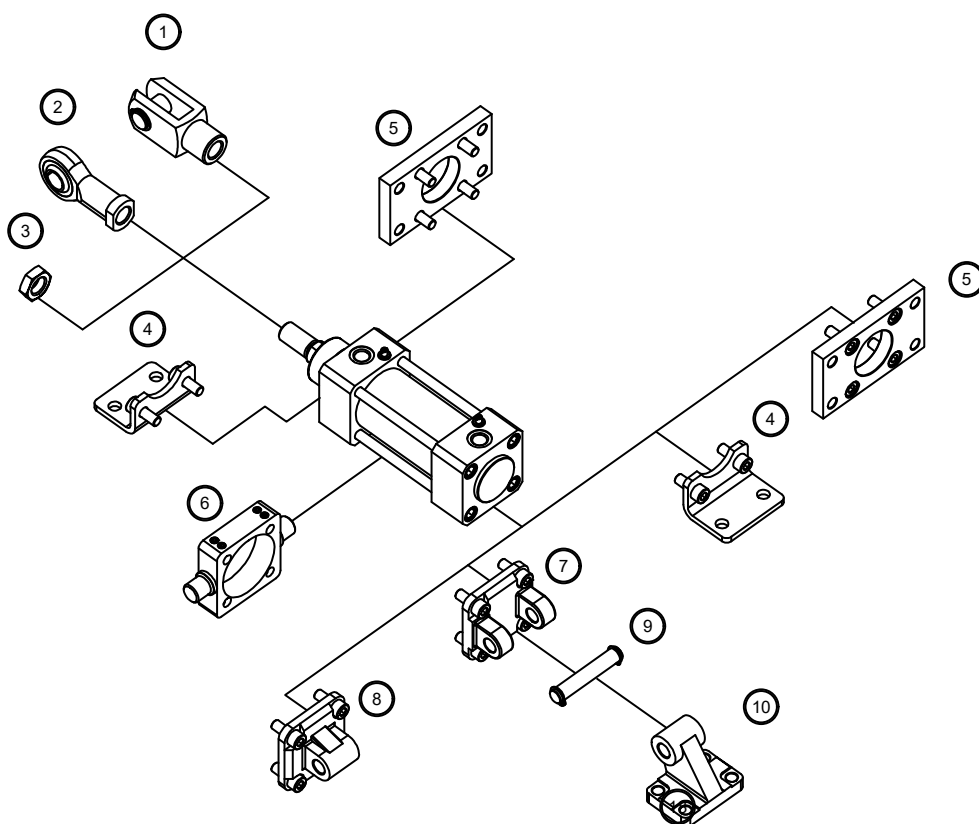

	Descrizione Description	Acciaio inox Stainless steel
1	Forcella / Clevis	147
2	Testa a snodo / Rod end	148
3	Dado per aste / Piston rod nut	146
4	Piedino basso / Low-rise pedestal (MS1)	152
5	Flangia / Flange (MF1-MF2)	152
6	Cerniera intermedia per cilindri tiranti / Intermediate hinge for tie rods cylinders (MT4)	153
7	Cerniera femmina / Female hinge (MP2)	150
8	Cerniera maschio / Male hinge (MP4)	151
9	Perno per cerniera femmina / Pivot for female hinge (AA4)	150
10	Articolazione a squadra / Square joint (AB7)	151