

# CILINDRI ISO 15552 INOX Ø160-200 ISO 15552 STAINLESS STEEL CYLINDERS Ø160-200



Cilindri costruiti a norma ISO 15552 in versione interamente inox. Caratterizzato dal design pulito e da grande resistenza e precisione di montaggio.

Disponibili in versione magnetica o non, con o senza ammortizzo regolabile, a stelo singolo o passante.

Ampia gamma di accessori.

Su richiesta sono fornibili in varie esecuzioni speciali ed in versione conforme alla direttiva 2014/34/UE ATEX.

ISO 15552 cylinders, stainless steel version.

Featuring a clean design, high resistance and mounting precision. Available with or without magnet, with or without adjustable cushioning, single or through piston rod.

Wide range of mounting accessories. Special versions are available. On request compliant with 2014/34/UE ATEX directive.

## VERSIONE VERSION

CDE		CDEP	
CDEM		CDEMP	
CDEA		CDEAP	
CDEMA		CDEMAP	

## INFORMAZIONI TECNICHE TECHNICAL INFORMATION

Testate Covers	Acciaio inox AISI304 AISI304 Stainless steel
Tubo Tube	Acciaio inox AISI304 AISI304 Stainless steel
Guarnizioni Seals	Poliuretano - NBR Polyurethane - NBR
Boccola guida Guiding bush	Bronzo sinterizzato Sintered bronze
Stelo Piston rod	Acciaio inox AISI316 AISI316 Stainless steel
Tiranti Tie rods	Acciaio inox AISI304 AISI304 Stainless steel
Pressione MAX MAX pressure	10 bar
Temperatura di impiego Working temperature	-20°C +80°C con aria secca -20°C +80°C with dry air
Fluido Working fluid	Aria compressa filtrata e lubrificata e non Filtered and lubricated or not compressed air

## CHIAVI DI CODIFICA CYLINDERS KEY CODE

Versione Version		Diametro Diameter	Corsa Stroke	Tipo costruttivo Design Type	Guarnizioni Seals
CDE	Doppio effetto non magnetico Double acting non magnetic	160	0...2700	XF	- Standard
CDEM	Doppio effetto magnetico Double acting magnetic	200		ISO 15552 standard ISO 15552 standard	V Guarnizioni FKM FKM seals
CDEA	Doppio effetto con ammortizzo regolabile non magnetico Double acting with adjustable cushioning non magnetic				VG Guarnizione stelo FKM FKM rod seal
CDEMA	Doppio effetto con ammortizzo regolabile magnetico Double acting with adjustable cushioning magnetic				
CDEP	Doppio effetto stelo passante non magnetico Double acting through rod non magnetic				
CDEMP	Doppio effetto stelo passante magnetico Double acting through rod magnetic				
CDEAP	Doppio effetto stelo passante con ammortizzo regolabile non magnetico Double acting through rod with adjustable cushioning non magnetic				
CDEMAP	Doppio effetto stelo passante con ammortizzo regolabile magnetico Double acting through rod with adjustable cushioning magnetic				











## CORSE STANDARD STANDARD STROKES

Ø (mm)	Corse standard (mm) Standard strokes (mm)													
160	10	25	40	50	80	100	125	160	200	250	300	320	400	500
200	10	25	40	50	80	100	125	160	200	250	300	320	400	500

## FORZE TEORICHE A 6 BAR THEORETICAL FORCES AT 6 BAR

Ø (mm)	Forza di spinta (N) Thrust force (N)	Forza di trazione (N) Traction force (N)
160	12058	11304
200	18840	18086

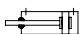
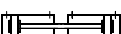
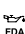
## VARIANTI VARIANTS

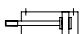
Simbolo Symbol	Caratteristiche Features	Simbolo Symbol	Caratteristiche Features
	Resistente alle alte temperature -10...+150°C Heat-resistant -10...+150°C		Certificazione ATEX ATEX certification
	Resistente alle basse temperature -40...+80°C Low temperature resistant -40...+80°C		Guarnizione stelo ad elevata resistenza chimica Rod seal with increased chemical resistance
	Stelo prolungato Piston rod extension		Configurazione tandem a più posizioni Multi position configuration
	Basso attrito Low friction		Configurazione tandem a doppia spinta Double thrust tandem configuration
	Raschia stelo duro in poliestere Hard wiper in polyester		Configurazione tandem contrapposti anteriore Front opposed tandem configuration
	Lubrificazione FDA FDA lubrication		Configurazione tandem contrapposti posteriore Rear opposed tandem configuration
	Filettature e steli su richiesta Custom made thread or piston rod		

# CILINDRI ISO 15552 INOX Ø160-200 ISO 15552 STAINLESS STEEL CYLINDERS Ø160-200

**DOPPIO EFFETTO**  
**DOUBLE ACTING**

**CDEØ/...XF**

**CDEMØ/...XF**

**CDEAØ/...XF**

**CDEMAØ/...XF**

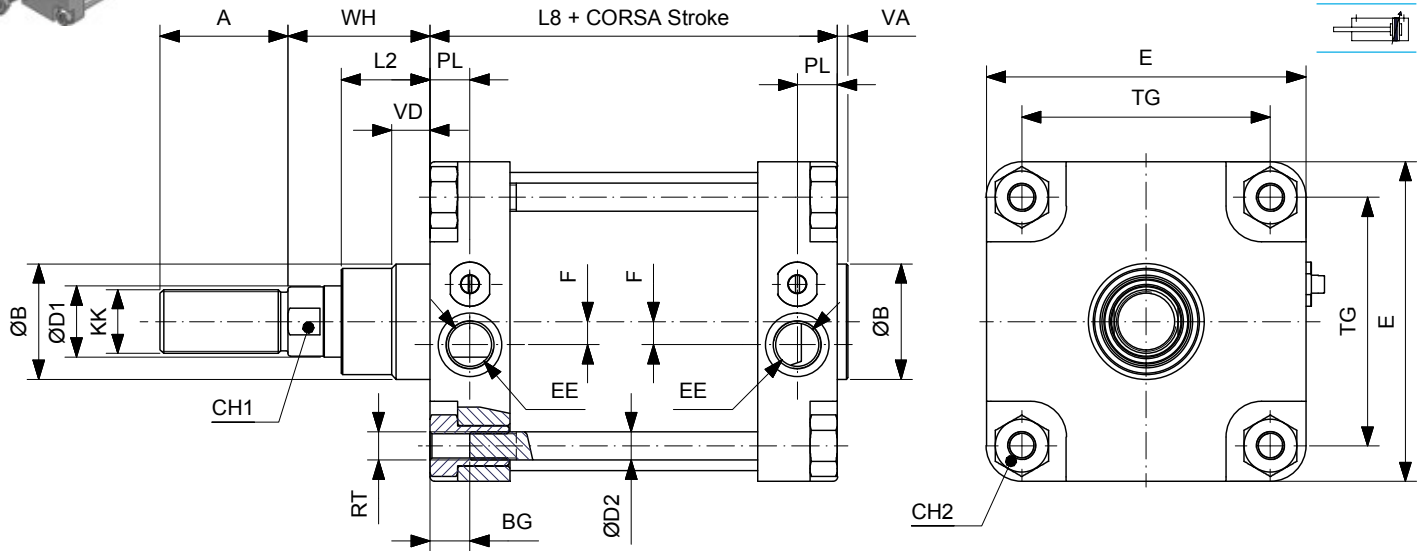

Ø mm	ØD1	ØD2	KK	A	ØB	VD	VA	L2	RT	BG	TG	EE	F	PL	WH	L8	E	CH1	CH2
160	40	16	M36X2	72	65	21.5	6	50	M16X2	24	140	3/4"G	13	22.5	80	179.5	180	36	30
200	40	16	M36X2	72	75	26.5	6	55	M16X2	24	175	3/4"G	13	22.5	95	180	220	36	30

**DOPPIO EFFETTO PASSANTE**  
**DOUBLE ACTING THROUGH PISTON ROD**

**CDEPØ/...XF**

**CDEMPØ/...XF**

**CDEAPØ/...XF**

**CDEMAPØ/...XF**

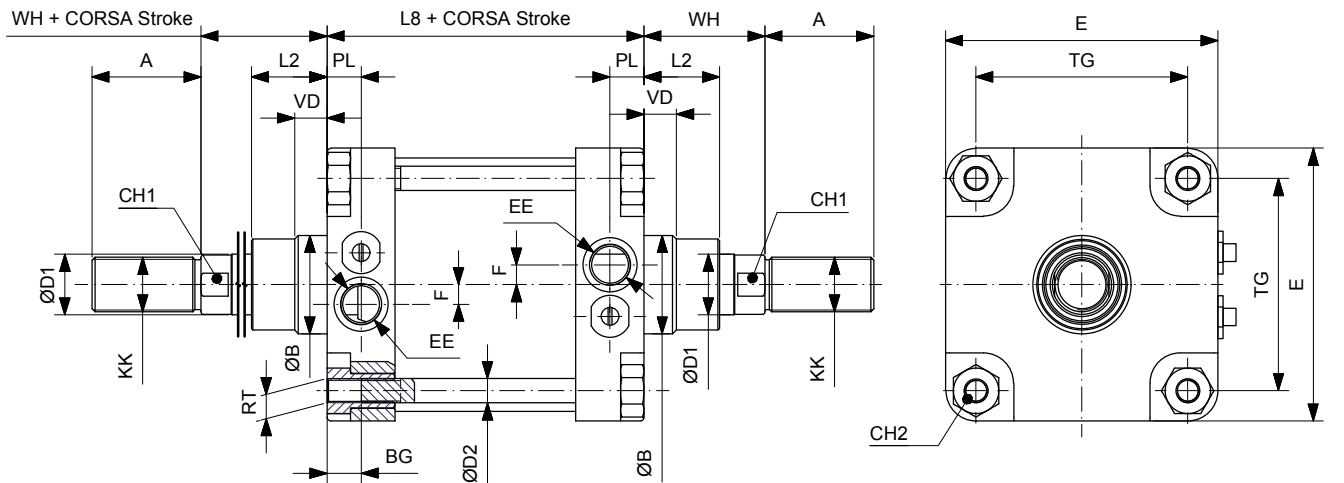

Ø mm	ØD1	ØD2	KK	A	ØB	VD	L2	RT	BG	TG	EE	F	PL	WH	L8	E	CH1	CH2
160	40	16	M36X2	72	65	21.5	50	M16X2	24	140	3/4"G	13	22.5	80	179.5	180	36	30
200	40	16	M36X2	72	75	26.5	55	M16X2	24	175	3/4"G	13	22.5	95	180	220	36	30

## ACCESSORI DI FISSAGGIO MOUNTING ACCESSORIES

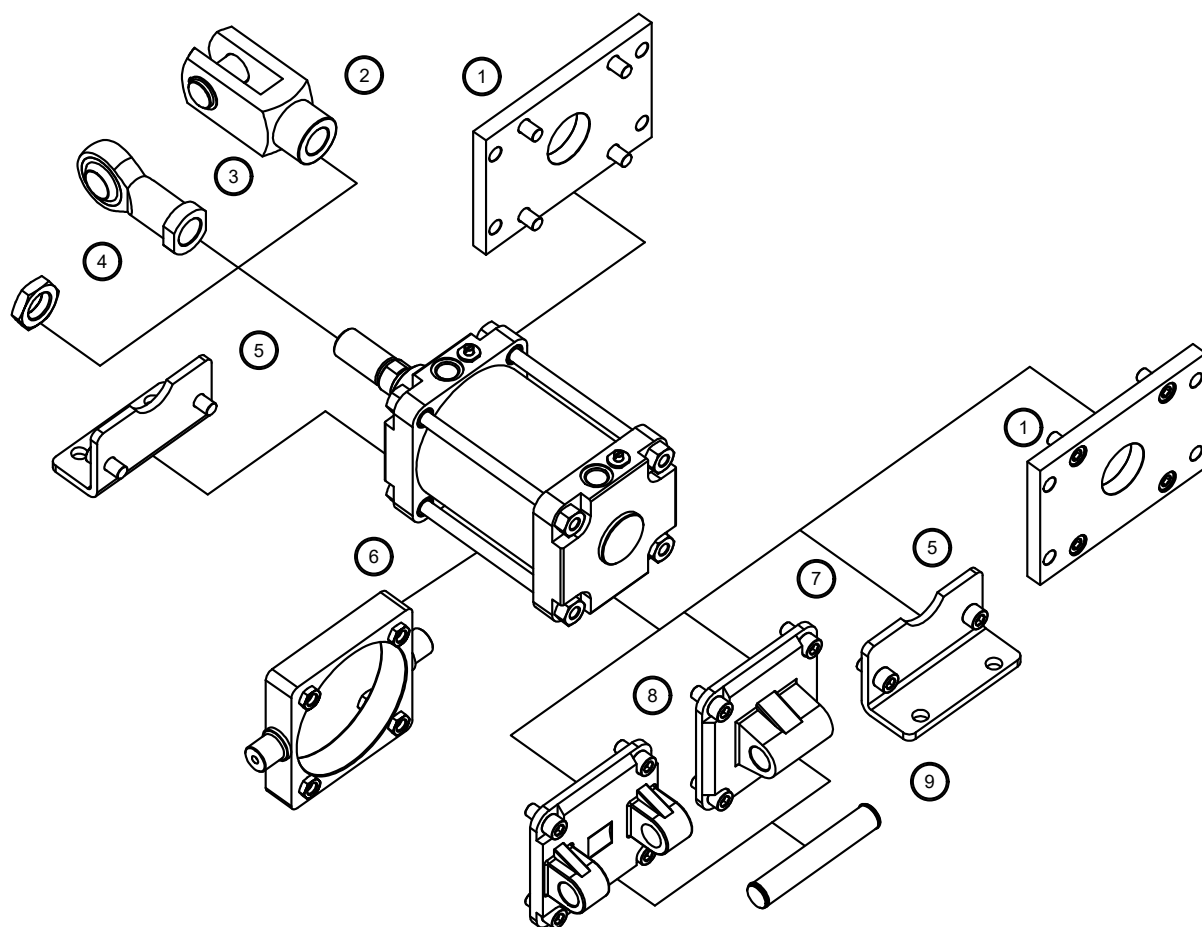

	Descrizione Description	Acciaio inox Stainless steel
1	Flangia / Flange (MF1-MF2)	152
2	Forcella / Clevis	147
3	Testa a snodo / Rod end	148
4	Dado per aste / Piston rod nut	146
5	Piedino basso / Low-rise pedestal (MS1)	152
6	Cerniera intermedia per cilindri tiranti / Intermediate hinge for tie rods cylinders (MT4)	153
7	Cerniera maschio / Male hinge (MP4)	151
8	Cerniera femmina / Female hinge (MP2)	150
9	Perno per cerniera femmina / Pivot for female hinge (AA4)	150