

# CILINDRI ISO 15552 EASY LINE Ø32-100 ISO 15552 EASY LINE CYLINDERS Ø32-100



Cilindri costruiti a norma ISO 15552 in versione Easy Line. Design essenziale e leggero senza compromettere la qualità. Disponibili in versione magnetica o non, con o senza ammortizzo regolabile, a stelo singolo o passante. Ampia gamma di accessori. Su richiesta sono fornibili in varie esecuzioni speciali.

ISO 15552 cylinders, Easy Line version. Basic and light design without compromising on quality. Available with or without magnet, with or without adjustable cushioning, single or through piston rod. Wide range of mounting accessories. Special versions are available.

## VERSIONE VERSION

CDE		CDEP	
CDEM		CDEMP	
CDEA		CDEAP	
CDEMA		CDEMAP	

## INFORMAZIONI TECNICHE TECHNICAL INFORMATION

Testate Covers	Alluminio pressofuso verniciato Painted die-casted aluminium
Tubo Tube	Alluminio anodizzato Anodized aluminium
Guarnizioni Seals	Poliuretano - NBR Polyurethane - NBR
Boccola guida Guiding bush	Bronzo sinterizzato Sintered bronze
Stelo Piston rod	Acciaio cromato Chromium coated steel
Pressione MAX MAX pressure	10 bar
Temperatura di impiego Working temperature	-20°C +80°C con aria secca -20°C +80°C with dry air
Fluido Working fluid	Aria compressa filtrata e lubrificata e non Filtered and lubricated or not compressed air

## CHIAVI DI CODIFICA CYLINDERS KEY CODE

Versione Version		Diametro Diameter	Corsa Stroke	Tipo costruttivo Design Type	Stelo Piston rod	Guarnizioni Seals
CDEM		32	100	EL	-	V
CDE	Doppio effetto non magnetico Double acting non magnetic	32	0...2700	EL ISO 15552 Easy Line ISO 15552 Easy Line	- Acciaio cromato Chrome plated steel	- Standard
CDEM	Doppio effetto magnetico Double acting magnetic	40			I Acciaio inox AISI 304 AISI 304 Stainless steel	V Guarnizioni FKM FKM seals
CDEA	Doppio effetto con ammortizzo regolabile non magnetico Double acting with adjustable cushioning non magnetic	50				VG Guarnizione stelo FKM FKM rod seal
CDEMA	Doppio effetto con ammortizzo regolabile magnetico Double acting with adjustable cushioning magnetic	63				
CDEP	Doppio effetto stelo passante non magnetico Double acting through rod non magnetic	80				
CDEMP	Doppio effetto stelo passante magnetico Double acting through rod magnetic	100				
CDEAP	Doppio effetto stelo passante con ammortizzo regolabile non magnetico Double acting through rod with adjustable cushioning non magnetic					
CDEMAP	Doppio effetto stelo passante con ammortizzo regolabile magnetico Double acting through rod with adjustable cushioning magnetic					









## CORSE STANDARD STANDARD STROKES

Ø (mm)	Corse standard (mm) Standard strokes (mm)													
32	10	25	40	50	80	100	125	160	200	250	300	320	400	500
40	10	25	40	50	80	100	125	160	200	250	300	320	400	500
50	10	25	40	50	80	100	125	160	200	250	300	320	400	500
63	10	25	40	50	80	100	125	160	200	250	300	320	400	500
80	10	25	40	50	80	100	125	160	200	250	300	320	400	500
100	10	25	40	50	80	100	125	160	200	250	300	320	400	500

## FORZE TEORICHE A 6 BAR THEORETICAL FORCES AT 6 BAR

Ø (mm)	Forza di spinta (N) Thrust force (N)	Forza di trazione (N) Traction force (N)
32	482	414
40	754	633
50	1178	989
63	1869	1681
80	3014	2720
100	4710	4416

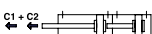
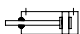
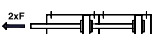
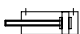
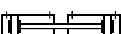
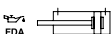
## VARIANTI VARIANTS

Simbolo Symbol	Caratteristiche Features	Simbolo Symbol	Caratteristiche Features
	Resistente alle alte temperature -10...+150°C Heat-resistant -10...+150°C		Filettature e steli su richiesta Custom made thread or piston rod
	Resistente alle basse temperature -40...+80°C Low temperature resistant -40...+80°C		Certificazione ATEX ATEX certification
	Stelo prolungato Piston rod extension		Guarnizione stelo ad elevata resistenza chimica Rod seal with increased chemical resistance
	Basso attrito Low friction		Configurazione tandem a più posizioni Multi position configuration
	Raschia stelo duro in poliestere Hard wiper in polyester		Configurazione tandem a doppia spinta Double thrust tandem configuration
	Stelo in acciaio inox Stainless steel piston rod		Configurazione tandem contrapposti anteriore Front opposed tandem configuration
	Lubrificazione FDA FDA lubrication		Configurazione tandem contrapposti posteriore Rear opposed tandem configuration

# CILINDRI ISO 15552 EASY LINE Ø32-100 ISO 15552 EASY LINE CYLINDERS Ø32-100

**DOPPIO EFFETTO**  
**DOUBLE ACTING**

CDEØ/...EL

CDEMØ/...EL

CDEAØ/...EL

CDEMAØ/...EL

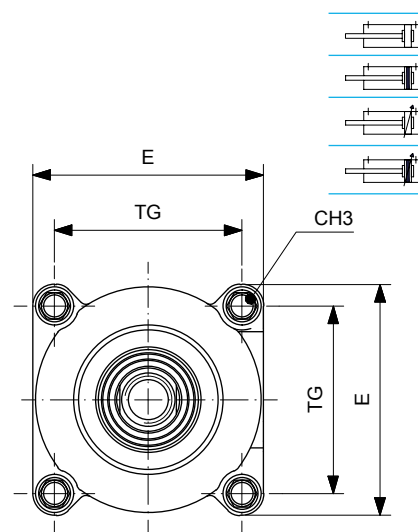
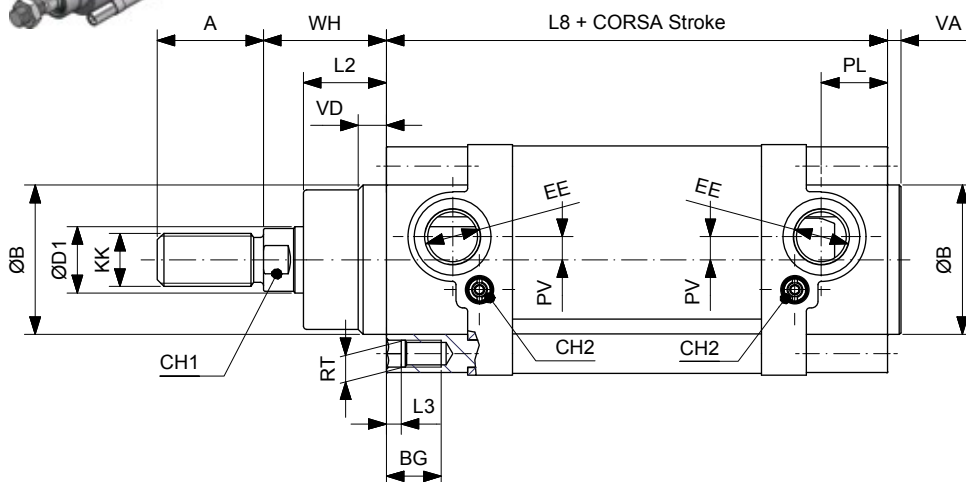

Ømm	ØD1	KK	A	ØB	VD	VA	L2	RT	BG	L3	TG	EE	PL	PV	WH	L8	E	CH1	CH2	CH3
32	12	M10x1.25	22	30	8	4	18	M6	16.5	5	32.5	1/8"G	12.5	-	26	94	44	10	3	6
40	16	M12x1.25	24	35	12	4	22	M6	16.5	5	38	1/4"G	14	-	30	105	51	13	3	6
50	20	M16x1.5	32	40	10.5	4	25.5	M8	16.5	4.5	46.5	1/4"G	14	-	37	106	59.5	17	3	8
63	20	M16x1.5	32	45	8.5	4	25	M8	16.5	4.5	56.5	3/8"G	20	7	37	121	69.5	17	3	8
80	25	M20x1.5	40	45	10	4	35	M10	17	-	72	3/8"G	18.5	6.5	46	128	87	22	4	-
100	25	M20x1.5	40	55	12.5	4	38	M10	17	-	89	1/2"G	20	12	51	138	106.5	22	4	-

**DOPPIO EFFETTO PASSANTE**  
**DOUBLE ACTING THROUGH PISTON ROD**

CDEPØ/...EL

CDEMPØ/...EL

CDEAPØ/...EL

CDEMAPØ/...EL

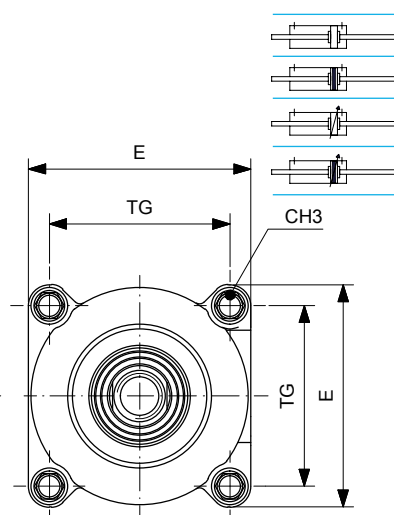
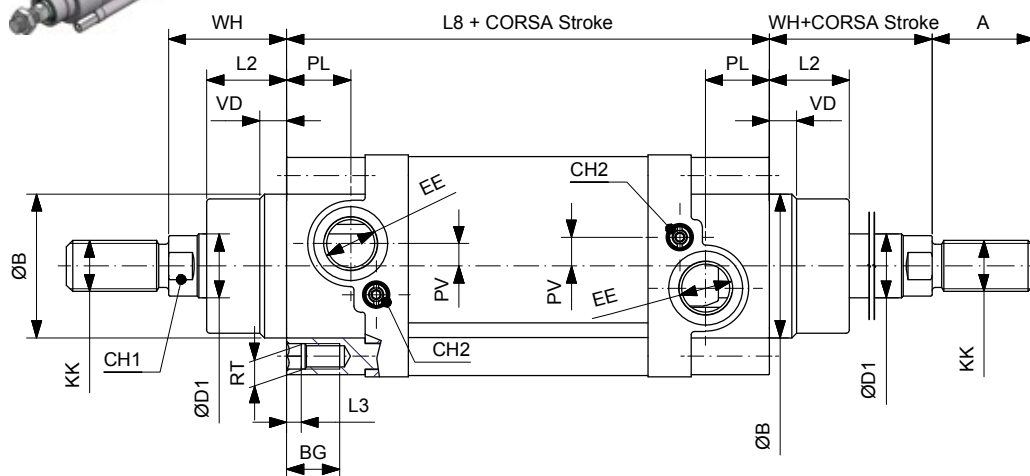

Ømm	ØD1	KK	A	ØB	VD	L2	RT	BG	L3	TG	EE	PL	PV	WH	L8	E	CH1	CH2	CH3
32	12	M10x1.25	22	30	8	18	M6	16.5	5	32.5	1/8"G	12.5	-	26	94	44	10	3	6
40	16	M12x1.25	24	35	12	22	M6	16.5	5	38	1/4"G	14	-	30	105	51	13	3	6
50	20	M16x1.5	32	40	10.5	25.5	M8	16.5	4.5	46.5	1/4"G	14	-	37	106	59.5	17	3	8
63	20	M16x1.5	32	45	8.5	25	M8	16.5	4.5	56.5	3/8"G	20	7	37	121	69.5	17	3	8
80	25	M20x1.5	40	45	10	35	M10	17	-	72	3/8"G	18.5	6.5	46	128	87	22	4	-
100	25	M20x1.5	40	55	12.5	38	M10	17	-	89	1/2"G	20	12	51	138	106.5	22	4	-

## ACCESSORI DI FISSAGGIO MOUNTING ACCESSORIES

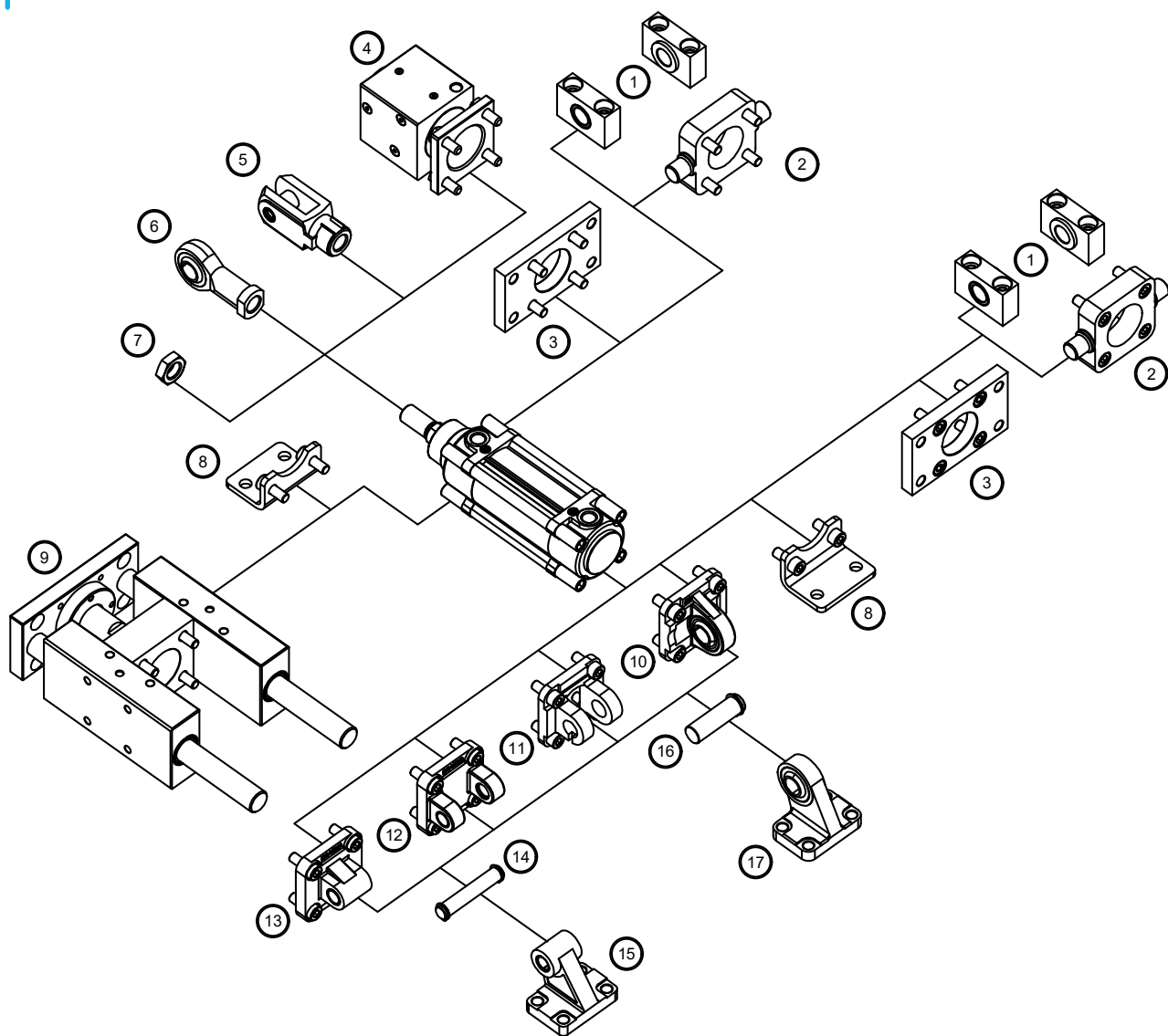

Descrizione Description	Alluminio Alluminium	Acciaio Steel	Acciaio inox Stainless steel
1 Supporto per cerniera intermedia / Support for intermediate hinge (AT4)	-	142	-
2 Cerniera oscillante anteriore-posteriore / Front-rear trunnion (MT5 / MT6)	-	142	-
3 Flangia / Flange (MF1-MF2)	-	139	152
4 Bloccastelo / Rod lock	126	-	-
5 Forcella / Clevis	-	131	147
6 Testa a snodo / Rod end	-	132	148
7 Dado per aste / Piston rod nut	-	130	146
8 Piedino basso / Low-rise pedestal (MS1)	-	138	152
9 Unità di guida / Guide unit	122	-	-
10 Cerniera maschio snodata / Male hinge with spherical bearing (MP6)	137	143	-
11 Cerniera stretta per snodo sferico AB6 / Clevis braket, spherical eye, straight AB6	136	142	-
12 Cerniera femmina / Female hinge (MP2)	134	142	150
13 Cerniera maschio / Male hinge (MP4)	135	-	151
14 Perno per cerniera femmina / Pivot for female hinge (AA4)	-	135	150
15 Articolazione a squadra / Square joint (AB7)	137	-	151
16 Perno per cerniera snodata AA6 / Pivot pin, spherical bearing AA6	-	136	-
17 Articolazione a squadra con testina snodata DIN 648 K / Square joint with spherical head DIN 648 K	-	138	-
18 Giunto autoallineante / Self-aligning joint	-	131	-