

# **RACCORDI STANDARD E ACCESSORI**

*Standard Fittings and Accessories*

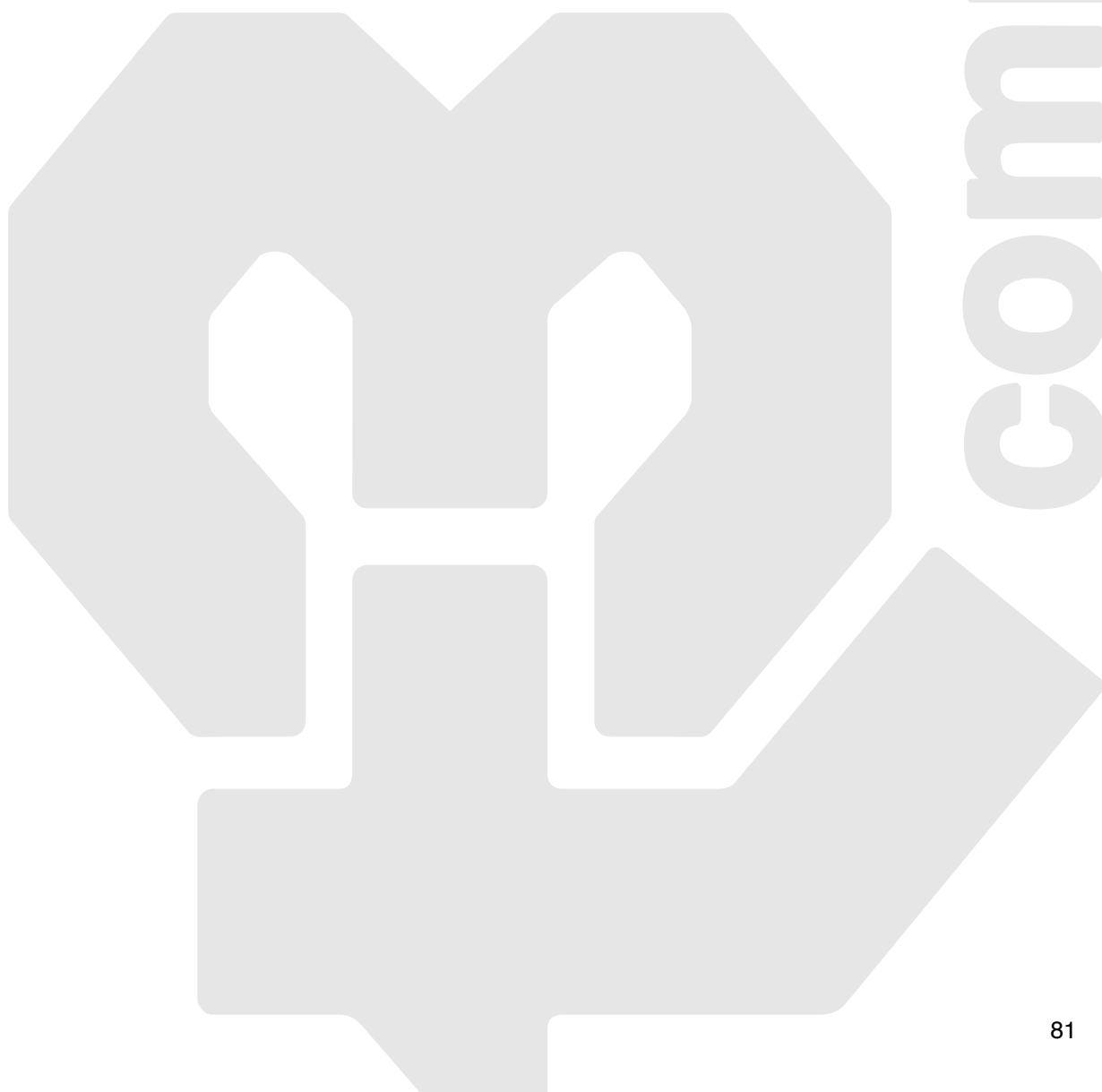

components

The standard fittings consist of those items useful to connect different components in order to complete all other fitting series.

The fittings of the series “accessories” are several, so it is impossible to define precise pressure values for each item.

In the schedule below we quoted the maximum pressure got from tests carried out by adopting a safety coefficient 4.



<b>Standard supply</b>	Ø Tube from 4 to 40 mm Threading from M5 to 1" 1/4"	
<b>Material</b>	Nikelated brass - Aluminium - Zinc - Plated steel Sea in Nbr (Viton upon request)	
<b>Pressure</b>	Threading from 1/8	Max 150 bar
	Threading from 1/4	Max 100 bar
	Threading from 3/8	Max 80 bar
	Threading from 1/2	Max 50 bar
	Threading from 3/4	Max 85 bar
	Threading from 1"	Max 80 bar
	Threading from 1" 1/4	Max 70 bar
<b>Use temperature</b>	-15°C +80°C	
<b>Threading</b>	Conic gas	Iso 7.1 Din 2999
	Cylindric gas	Iso 228 classe A
	Metrical	Iso R/262
<b>Use</b>	Compressed air - Water - Oil - Vacuum	
<b>Options</b>	V (See pag. 3)	



La raccorderia “standard” è composta da tutti quegli articoli che servono a collegare fra di loro componenti di vario genere e fungono da completamento a tutte le altre serie di raccordi.

I raccordi della serie “Accessori” sono di tanti tipi e genere, pertanto risulta impossibile definire dei valori di pressione precisi per singolo articolo.

Nella tabella sottostante riportiamo le pressioni massime consigliate ricavate da prove effettuate adottando un coefficiente di sicurezza 4.

Ø Tubo da 4 a 40 mm Filetto da M5 a 1” 1/4”		<b>Disponibilità standard</b>
Ottone Nichelato - Alluminio - Acciaio Zincato Guarnizione in Nbr (Viton su richiesta)		<b>Materiali</b>
Filetto da 1/8           Max 150 bar Filetto da 1/4           Max 100 bar Filetto da 3/8           Max 80 bar Filetto da 1/2           Max 50 bar Filetto da 3/4           Max 85 bar Filetto da 1”           Max 80 bar Filetto da 1” 1/4       Max 70 bar		<b>Pressione</b>
-15°C +80°C		<b>Temperatura di utilizzo</b>
Gas Coniche           Iso 7.1 Din 2999 Gas Cilindriche       Iso 228 classe A Metriche                Iso R/262		<b>Filettature</b>
Aria Compressa- Acqua - Olio - Vuoto		<b>Impiego</b>
V (Vedi pag. 3)		<b>Opzioni</b>

### Raccordo a L maschio conico

Male elbow (taper)

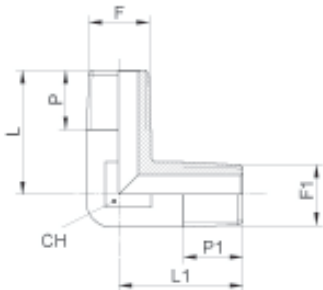

Code	F	F1	CH	P	P1	L	L1	Gr
L2010M5NI	M5	-	9	4,0	-	11,0	-	7,0
L201018NIRID	1/8	-	9	8,0	-	17,0	-	11,0
L201018NI	1/8	-	11	8,0	-	19,0	-	17,0
L20101814NI	1/8	1/4	11	8,0	11,0	19,0	21,0	19,0
L201014NIRID	1/4	-	11	11,0	-	20,5	-	21,0
L201014NI	1/4	-	14	11,0	-	24,0	-	30,0
L20101438NI	1/4	3/8	14	11,0	11,5	24,0	25,5	34,0
L201038NIRID	3/8	-	14	11,5	-	24,5	-	38,5
L201038NI	3/8	-	17	11,5	-	26,0	-	54,0
L201012NIRID	1/2	-	17	14,0	-	28,5	-	60,0
L201012NI	1/2	-	21	14,0	-	31,5	-	90,0
L201034NI	3/4	-	25	16,0	-	33,0	-	97,6
L20101NI	1"	-	30	17,5	-	39,0	-	171,8

### Raccordo a L femmina

Female elbow

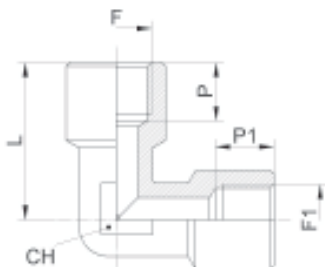

Code	F	F1	CH	P	P1	L	L1	Gr
L201M5NI	M5	-	9	3,0	-	11,0	-	8,0
L20118NI	1/8	-	12	8,0	-	21,0	-	22,0
L2011814NI	1/8	1/4	14	8,0	11,0	24,0	26,5	36,0
L20114NI	1/4	-	14	11,0	-	26,5	-	42,0
L2011438NI	1/4	3/8	17	11,0	12,0	26,0	28,0	62,0
L20138NI	3/8	-	17	12,0	-	28,0	-	70,0
L20112NI	1/2	-	21	14,0	-	33,5	-	120,0
L20134NI	3/4	-	25	16,5	-	36,5	-	143,0
L2011NI	1"	-	30	19,0	-	45,0	-	230,0

**Raccordo a L maschio femmina**

Male-female elbow

Code	F	F1	CH	P	P1	L	L1	Gr
L202M5NI	M5	M5	9	4,0	5,0	11,5	11,0	14,0
L20218NI	1/8	1/8	12	8,0	8,0	17,0	20,0	21,0
L2021814NI	1/8	1/4	11	8,0	11,0	19,0	23,0	33
L2021418NI	1/4	1/8	11	11,0	8,0	20,5	21,0	33
L20214NI	1/4	1/4	14	11,0	11,0	25,0	26,5	37,0
L2021438NI	1/4	3/8	17	11,0	11,5	25,0	28,0	50
L2023814NI	3/8	1/4	14	11,5	11,0	25,5	26,5	50
L20238NI	3/8	3/8	17	11,5	12,0	26,0	28,0	59,0
L20212NI	1/2	1/2	21	14,0	14,0	31,0	33,5	100,0
L20234NI	3/4	3/4	25	16,0	16,5	33,0	36,5	118,4
L2021NI	1"	1"	30	17,5	19,0	45,0	39,0	212,6

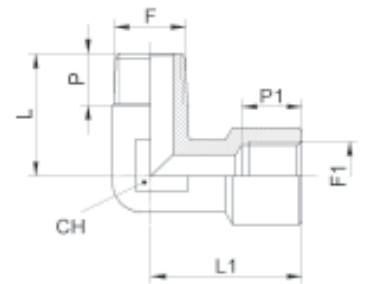

**Raccordo a Y 90° maschio conico**

Male 90° Y (taper)

Code	F	CH	P	P1	Gr
M20418NI	1/8	13	8,0	8,0	30,0
M20414NI	1/4	17	11,0	11,0	42,5
M20438NI	3/8	20	11,5	11,5	55,0
M20412NI	1/2	25	14,0	14,0	111,0

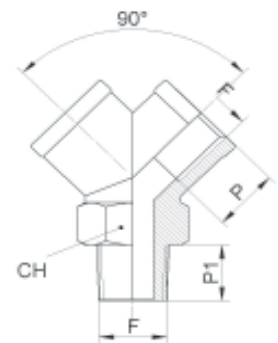

### Raccordo a Y 90° femmina

Female 90° Y (taper)



Code	F	CH	P	Gr
F20418NI	1/8	13	8,0	34,0
F20414NI	1/4	17	11,0	36,0
F20438NI	3/8	20	11,5	43,5
F20412NI	1/2	25	14,0	105,0

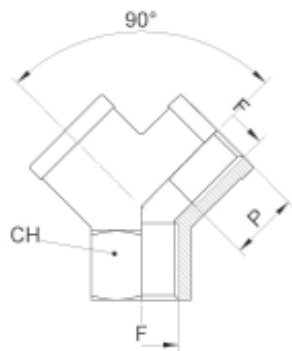

### Raccordo a T femmina

Female tee



Code	F	CH	P	L	Gr
TT200M5NI	M5	9	5,0	11,0	22,0
TT20018NI	1/8	10	9,0	20,5	30,5
TT20014NI	1/4	13	11,0	25,8	62,0
TT20038NI	3/8	17	12,0	30,0	100,0
TT20012NI	1/2	22	14,0	34,8	161,0
TT20034NI	3/4	25	16,5	36,5	194,0
TT2001NI	1"	30	19,0	45,0	265,0

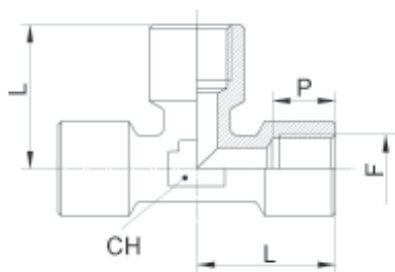

**Raccordo a T femmina laterale**

Offset female tee leg

Code	F	F1	CH	P	P1	L	L1	Gr
TL20518NI	1/8	1/8	10	8,0	9,0	19,5	19,5	22,5
TL20514NI	1/4	1/4	13	11,0	11,0	25,8	24,8	51,5
TL20538NI	3/8	3/8	17	11,5	13,0	30,0	28,5	81,0
TL20512NI	1/2	1/2	22	14,0	14,0	34,8	31,8	137,0
TL20534NI	3/4	3/4	25	16,0	16,5	34,8	33,0	165,0
TL2051NI	1"	1"	30	17,5	19,0	42,0	39,0	250,0

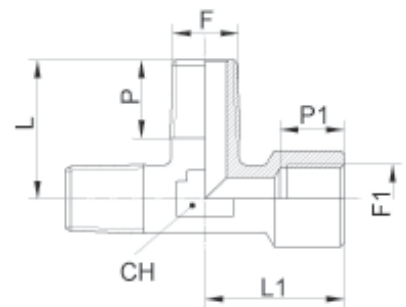

**Raccordo a T maschio centrale**

Offset male tee leg

Code	F	F1	CH	P	P1	L	L1	Gr
TC206M5NI	M5	M5	9	4,0	5,0	11,5	11,0	10,0
TC20618NI	1/8	1/8	10	8,0	9,0	19,5	19,5	26,5
TC20614NI	1/4	1/4	13	11,0	11,0	24,8	25,8	55,5
TC20638NI	3/8	3/8	17	11,5	13,0	28,5	30,0	90,0
TC20612NI	1/2	1/2	22	14,0	14,0	31,8	34,8	152,0
TC20634NI	3/4	3/4	25	16,0	16,5	33,0	36,5	175,0
TC2061NI	1"	1"	30	17,5	19,0	39,0	45,0	255,0

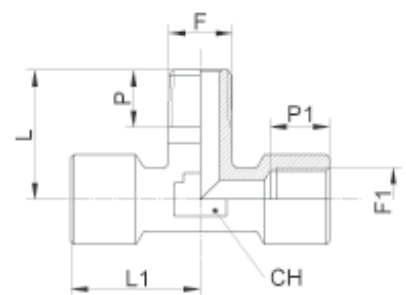

### Raccordo a T maschio laterale

Offset male tee leg



Code	F	F1	CH	P	P1	L	L1	Gr
TL207M5NI	M5	M5	9	4,0	5,0	22,5	11,3	10,0
TL20718NI	1/8	1/8	10	8,0	9,0	38,0	19,5	26,0
TL20714NI	1/4	1/4	13	11,0	11,0	50,5	25,8	55,0
TL20738NI	3/8	3/8	17	11,5	13,0	58,5	30,0	90,5
TL20712NI	1/2	1/2	22	14,0	14,0	66,5	34,8	143,0
TL20734NI	3/4	3/4	25	16,0	16,5	69,5	34,8	175,0
TL2071NI	1"	1"	30	17,5	19,0	84,0	42,0	255,0

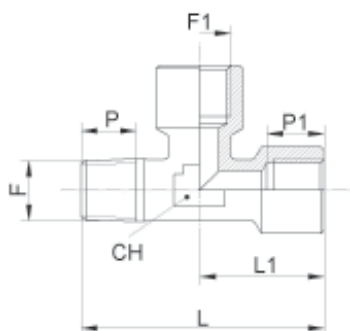

### Raccordo a T maschio conico

Male tee (taper)



Code	F	CH	P	L	L1	Gr
TT20818NI	1/8	10	8,0	18,5	19,0	14,2
TT20814NIRID	1/4	12	11,0	20,0	20,5	29,0
TT20814NI	1/4	13	11,0	24,75	24,75	55,0
TT20838NIRID	3/8	13	11,5	25,0	26,0	59,5
TT20838NI	3/8	17	11,5	28,5	28,5	93,0
TT20812NIRID	1/2	17	14,0	30,0	30,0	100,0
TT20812NI	1/2	22	14,0	31,75	31,75	142,0
TT20834NIRID	3/4	22	16,0	33,5	33,5	153,5
TT20834NI	3/4	25	16,2	33,2	33,0	170,0
TT2081NI	1"	30	17,5	39,0	39,0	235,0

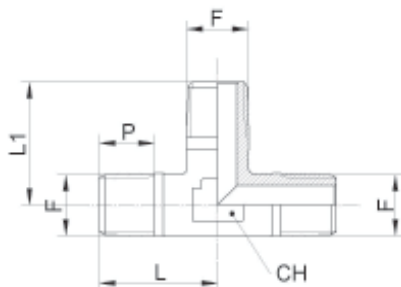



### Raccordo a T femmina centrale

Central female tee leg

Code	F	F1	CH	P	P1	L	L1	Gr
TC20918NI	1/8	1/8	10	8,0	9,0	20,5	18,5	22,5
TC20914NI	1/4	1/4	13	11,0	11,0	25,8	24,8	49,0
TC20938NI	3/8	3/8	17	11,5	13,0	28,5	28,5	79,5
TC20912NI	1/2	1/2	22	14,0	14,0	34,8	31,8	138,5
TC20934NI	3/4	3/4	25	16,2	16,5	36,5	33,2	170,0
TC2091NI	1"	1"	30	17,5	19,0	45,0	36,5	250,0

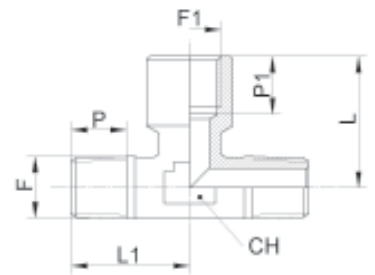

### Raccordo a croce femmina

Female equal cross

Code	F	CH	P	L	Gr
CR20318NI	1/8	10	8,0	21,0	40,5
CR20314NI	1/4	13	11,0	25,5	81,5
CR20338NI	3/8	17	11,5	28,0	130,0
CR20312NI	1/2	21	14,0	33,5	196,0

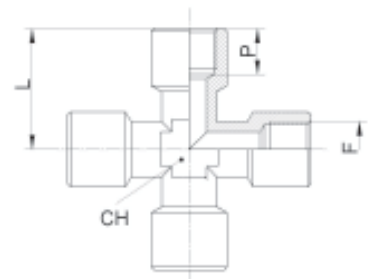

### Raccordo a croce maschio - femmina

Male - female equal cross



Code	F	F1	CH	P	P1	L	L1	Gr
CT203318NI	1/8	1/8	10	8,0	8,0	18,5	21,0	38,5
CT203314NI	1/4	1/4	13	11,0	11,0	23,5	25,5	72,0
CT203338NI	3/8	3/8	17	11,5	11,5	26,0	28,0	117,0
CT203312NI	1/2	1/2	21	14,0	14,0	31,0	33,5	185,0

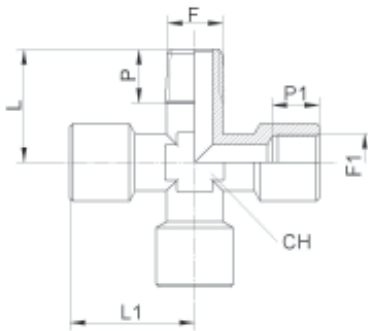

### Anello orientabile femmina

Female single banjo body



Code	F	D1	L	L1	Gr
RA230M5NI	M5	5,1	9,0	13,5	6,2
RA23018NI	1/8	9,9	14,5	22,0	17,0
RA23014NI	1/4	13,3	14,5	25,5	25,5

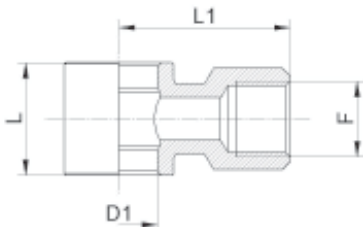

**Raccordo a L maschio - femmina conico**

Male - female elbow (taper)

Code	F	F1	CH	P	L	Gr.
RLB10018NI	1/8	1/8	14	8,0	22,0	18,0
RLB10014NI	1/4	1/4	18	10,0	28,0	36,0

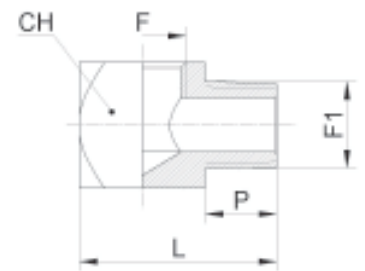

**Raccordo a L maschio - femmina cilindrico**

Male - female elbow (parallel)

Code	F	F1	CH	P	L	Gr.
RLB200M5NI	M5	M5	9	4,0	13,0	5,0
RLB20018NI	1/8	1/8	14	6,0	20,0	16,8
RLB20014NI	1/4	1/4	18	8,0	26,0	37,6

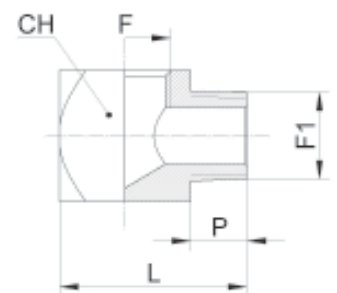

### Niplo conico Nipple (taper)



Code	F	F1	CH	P	P1	L	Gr
NC25018NI	1/8	1/8	12	7,5	7,5	20,0	9,0
NC25014NI	1/4	1/4	14	10,5	10,5	26,0	15,0
NC25038NI	3/8	3/8	17	11,5	11,5	28,0	26,0
NC25012NI	1/2	1/2	22	14,0	14,0	33,5	50,0
NC25034NI	3/4	3/4	27	14,0	14,0	35,0	72,0
NC2501NI	1"	1"	34	19,0	19,0	46,0	141,0

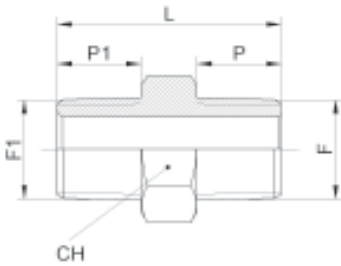

### Niplo di riduzione conico Reducing nipple (taper)



Code	F	F1	CH	P	P1	L	Gr
NR2511814NI	1/8	1/4	14	7,5	10,5	23,0	13,5
NR2511838NI	1/8	3/8	17	7,5	11,5	24,0	19,5
NR2511812NI	1/8	1/2	22	7,5	14,0	27,0	34,0
NR2511438NI	1/4	3/8	17	10,5	11,5	27,0	22,0
NR2511412NI	1/4	1/2	22	11,5	14,0	32,0	39,0
NR2511434NI	1/4	3/4	27	11,5	14,0	32,0	58,5
NR2513812NI	3/8	1/2	22	11,5	14,0	32,0	43,0
NR2513834NI	3/8	3/4	27	11,5	14,0	32,0	61,0
NR2511234NI	1/2	3/4	27	14,0	14,0	35,0	69,0
NR251341NI	3/4	1"	34	16,0	19,0	43,0	125,5

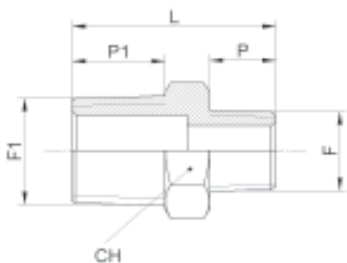

### Niplo cilindrico

Nipple (parallel)

Code	F	F1	CH	P	P1	L	Gr
NC260M5NI	M5	M5	8	4,0	4,0	11,5	3,0
NC26018NI	1/8	1/8	14	6,0	6,0	17,0	9,5
NC26014NI	1/4	1/4	17	8,0	8,0	21,0	15,5
NC26038NI	3/8	3/8	19	9,0	9,0	24,0	25,0
NC26012NI	1/2	1/2	24	10,0	10,0	26,0	45,0
NC26034NI	3/4	3/4	30	11,0	11,0	29,0	69,0
NC2601NI	1"	1"	33	14,5	14,5	37,0	75,5

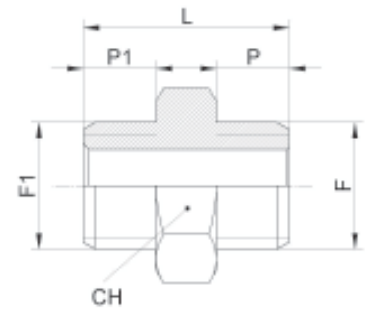

### Niplo di riduzione cilindrico

Reducer Nipple (parallel)

Code	F	F1	CH	P	P1	L	Gr
NR261M518NI	M5	1/8	14	4,0	6,0	14,0	8,6
NR2611814NI	1/8	1/4	17	6,0	8,0	19,0	13,5
NR2611838NI	1/8	3/8	19	6,0	9,0	20,0	19,5
NR2611812NI	1/8	1/2	24	6,0	10,0	22,0	33,5
NR2611438NI	1/4	3/8	19	8,0	9,0	22,0	22,0
NR2611412NI	1/4	1/2	24	8,0	10,0	24,0	39,0
NR2611434NI	1/4	3/4	30	8,0	11,0	25,0	53,4
NR2613812NI	3/8	1/2	24	9,0	10,0	25,0	43,0
NR2613834NI	3/8	3/4	30	9,0	11,0	26,0	61,0
NR2611234NI	1/2	3/4	30	10,0	11,0	28,0	69,0
NR261121NI	1/2	1"	36	10,0	14,0	35,0	73,2
NR261341NI	3/4	1"	36	14,5	14,0	38,5	101,2

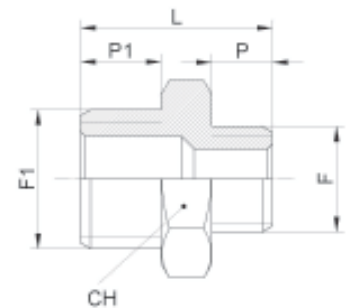

### Niplo conico 3 pezzi

Nipple (taper) - 3 pieces



Code	F	CH	CH2	P	L	C	Gr
NC27018NI	1/8	15	5	9,0	27,0	8,6	18,5
NC27014NI	1/4	19	6	11,5	33,5	9,6	36,0
NC27038NI	3/8	22	8	13,0	36,0	10,0	66,0
NC27012NI	1/2	27	12	15,5	45,0	12,0	88,0
NC27034NI	3/4	36	14	18,0	53,0	17,0	200,0
NC2701NI	1"	46	19	22,0	64,0	20,0	360,0

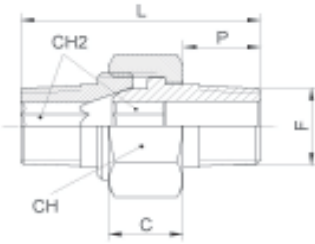

### Niplo di riduzione conico - 3 pezzi

Reducing nipple (taper) - 3 pieces



Code	F	F1	CH	CH2	P	P1	L	C	Gr
NR2711814NI	1/8	1/4	15	5	9,0	9,5	30,0	8,5	24,0
NR2711438NI	1/4	3/8	19	6	11,5	11,5	36,0	9,5	45,5
NR2713812NI	3/8	1/2	22	8	13,0	13,5	39,0	10,0	76,0

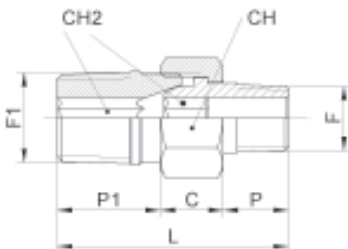

**Niplo femmina - 3 pezzi**

Female nipple - 3 pieces

Code	F	CH	CH1	CH2	P	P1	L	C	Gr
NC27518NI	1/8	14	15	5	9,0	10,0	30,5	8,5	19,0
NC27514NI	1/4	17	19	6	12,0	12,0	37,0	9,5	39,0
NC27538NI	3/8	21	22	8	12,0	12,0	40,0	10,0	68,0
NC27512NI	1/2	25	27	12	15,0	15,0	48,0	12,0	118,0

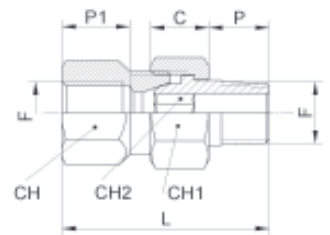

**Riduzione conica**

Reducer (taper)

Code	F	F1	CH	P	P1	L	Gr.
RC25318M5NI	1/8	M5	12	8,0	8,0	12,5	7,5
RC25318M6NI	1/8	M6	12	8,0	8,0	12,5	7,5
RC2531418NI	1/4	1/8	14	11,0	8,0	16,0	9,5
RC2533818NI	3/8	1/8	17	11,5	8,0	16,5	20,0
RC2533814NI	3/8	1/4	17	11,5	11,0	16,5	13,0
RC2531218NI	1/2	1/8	22	14,0	8,0	19,5	45,0
RC2531214NI	1/2	1/4	22	14,0	11,0	19,5	37,5
RC2531238NI	1/2	3/8	22	14,0	14,0	19,5	25,0
RC2533414NI	3/4	1/4	27	16,0	12,0	23,5	83,5
RC2533438NI	3/4	3/8	27	16,0	16,0	23,5	66,5
RC2533412NI	3/4	1/2	27	16,0	16,0	23,5	46,0
RC253114NI	1"	1/4	34	17,0	11,0	25,0	155,0
RC253138NI	1"	3/8	34	17,0	14,0	25,0	139,8
RC253112NI	1"	1/2	34	17,0	16,0	25,0	115,0
RC253134NI	1"	3/4	34	17,0	16,0	25,0	74,0

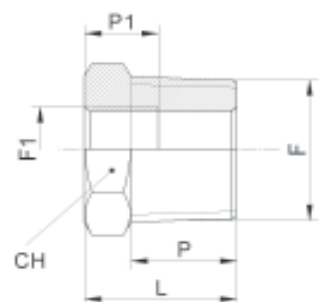

### Riduzione cilindrica passante

Passer by reducer (parallel)

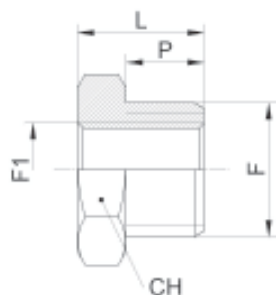

Code	F	F1	CH	P	L	Gr
RC10018M5NI	1/8	M5	14	6,0	10,5	8,0
RC10018M6NI	1/8	M6	14	6,0	10,5	8,0
RC1001418NI	1/4	1/8	17	8,0	13,0	10,5
RC1003818NI	3/8	1/8	19	9,0	14,0	19,0
RC1003814NI	3/8	1/4	19	9,0	14,0	13,0
RC1001218NI	1/2	1/8	24	10,0	15,5	39,0
RC1001214NI	1/2	1/4	24	10,0	15,5	32,0
RC1001238NI	1/2	3/8	24	10,0	15,5	24,0
RC1003414NI	3/4	1/4	30	11,0	17,5	70,0
RC1003438NI	3/4	3/8	30	11,0	17,5	58,0
RC1003412NI	3/4	1/2	30	11,0	17,5	41,0

### Riduzione cilindrica

Reducer (parallel)

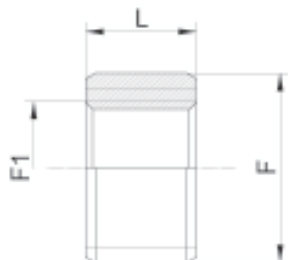

Code	F	F1	L	Gr
RC2001418NI	1/4	1/8	8,0	3,0
RC2003814NI	3/8	1/4	9,0	5,2
RC2001238NI	1/2	3/8	9,5	6,0
RC2003412NI	3/4	1/2	14,0	18,0
RC200134NI	1"	3/4	12,0	36,0
RC2001141NI	1"1/4	1"	12,0	44,0



**Riduzione conica**

Reducer (taper)

Code	F	F1	CH	P	P1	L	Gr.
RM25218NI	1/8	1/8	14	8,0	8,0	18,0	11,0
RM2521814NI	1/8	1/4	17	8,0	12,0	22,5	19,5
RM25214NI	1/4	1/4	17	11,0	12,0	25,5	22,5
RM2521838NI	1/8	3/8	22	8,0	12,0	23,0	26,5
RM2521438NI	1/4	3/8	22	11,0	12,0	26,0	33,0
RM25238NI	3/8	3/8	22	12,0	12,0	27,0	37,0
RM2521812NI	1/8	1/2	24	10,0	14,0	27,5	35,0
RM2521412NI	1/4	1/2	24	11,0	14,0	28,0	37,0
RM2523812NI	3/8	1/2	24	12,0	14,0	29,0	37,5
RM25212NI	1/2	1/2	24	14,0	14,0	31,0	46,0
RM2521434NI	1/4	3/4	30	11,0	14,0	28,0	53,4
RM2523834NI	3/8	3/4	30	12,0	14,0	29,0	51,6
RM2521234NI	1/2	3/4	30	14,0	14,0	31,0	62,5
RM25234NI	3/4	3/4	30	16,0	14,0	33,0	70,5

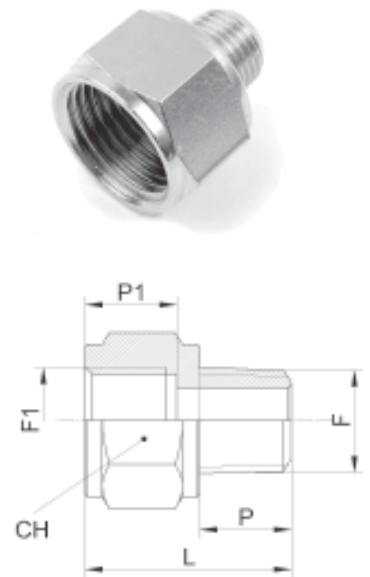

**Riduzione cilindrica**

Reducer (parallel)

Code	F	F1	CH	P	P1	L	Gr.
RM200M5NI	M5	M5	9	5,0	7,0	14,0	4,5
RM200M518NI	M5	1/8	14	5,0	8,0	15,0	9,0
RM200M618NI	M6	1/8	14	6,0	8,0	16,0	9,0
RM20018NI	1/8	1/8	14	6,0	8,0	16,0	10,0
RM2001814NI	1/8	1/4	17	6,0	12,0	20,5	18,5
RM20014NI	1/4	1/4	17	8,0	12,0	22,5	20,5
RM2001838NI	1/8	3/8	22	6,0	12,0	20,5	28,0
RM2001438NI	1/4	3/8	22	8,0	12,0	23,0	31,5
RM20038NI	3/8	3/8	22	9,0	12,0	24,0	35,0
RM2001812NI	1/8	1/2	24	7,0	14,0	24,0	52,0
RM2001412NI	1/4	1/2	24	8,0	14,0	25,0	35,0
RM2003812NI	3/8	1/2	24	9,0	14,0	26,0	37,0
RM20012NI	1/2	1/2	27	10,0	14,0	27,0	58,5
RM2001434NI	1/4	3/4	30	8,0	14,0	25,0	56,0
RM2003834NI	3/8	3/4	30	9,0	14,0	26,0	53,4
RM2001234NI	1/2	3/4	30	10,0	14,0	27,0	54,0

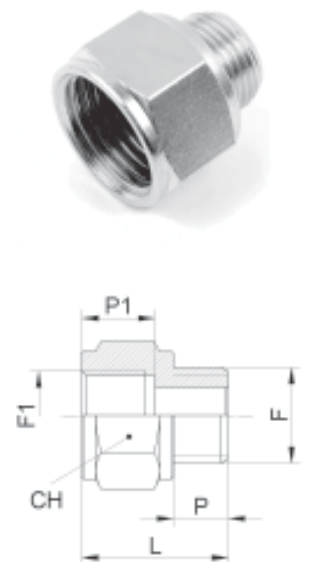

### Manicotto Sleeve

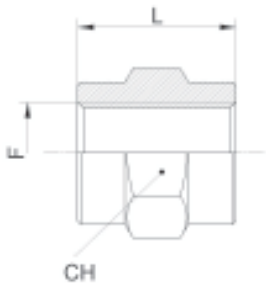

Code	F	CH	L	Gr
M25418NI	1/8	14	15,0	11,0
M25414NI	1/4	17	22,0	20,5
M25438NI	3/8	22	24,0	39,0
M25412NI	1/2	26	30,0	49,0
M25434NI	3/4	32	31,0	87,0
M2541NI	1"	41	38,0	180,0

### Manicotto di riduzione Reducing sleeve

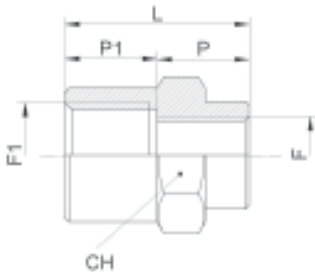

Code	F	F1	CH	P	P1	L	Gr
M2551814NI	1/8	1/4	17	8,0	10,0	22,0	25,0
M2551838NI	1/8	3/8	22	8,0	12,0	24,0	50,5
M2551438NI	1/4	3/8	22	8,0	8,0	23,0	46,5
M2551812NI	1/8	1/2	26	8,0	12,0	24,0	58,5
M2551412NI	1/4	1/2	26	10,0	12,0	24,0	55,0
M2553812NI	3/8	1/2	26	10,0	12,0	24,0	48,5
M2553834NI	3/8	3/4	32	10,0	14,0	30,0	120,0
M2551234NI	1/2	3/4	32	10,0	14,0	30,0	107,4
M255341NI	3/4	1"	41	16,0	19,0	38,0	180,0

### Tappo maschio cilindrico

Male plug (parallel)

Code	F	CH	P	L	Gr
E261M5NI	M5	8	4,0	7,5	2,0
E26118NI	1/8	14	6,0	11,0	8,0
E26114NI	1/4	17	8,0	13,0	12,0
E26138NI	3/8	19	9,0	14,5	18,0
E26112NI	1/2	24	9,0	15,0	27,0
E26134NI	3/4	30	11,0	17,0	55,6
E2611NI	1"	40	12,0	18,0	88,0

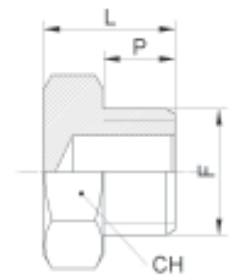

### Tappo testa cilindrica esagono incassato-ottone

Cylindrical head plug with embedded brass hexagon

Code	F	CH	P	L	Ø	Gr
E263M5NI	M5	2,5	4,0	5,6	8,0	4,0
E26318NI	1/8	5	6,0	8,0	14,0	6,6
E26314NI	1/4	6	8,0	10,0	18,0	15,0
E26338NI	3/8	8	9,0	12,0	22,0	24,4
E26312NI	1/2	10	11,0	14,0	26,0	43,8
E26334NI	3/4	12	16,0	20,0	32,0	80,4
E2631NI	1"	17	16,0	21,0	40,0	129,4

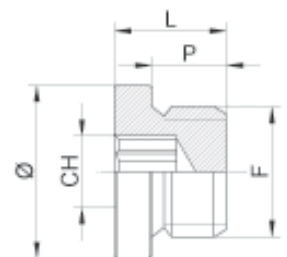

**Tappo testa cilindrica esagono incassato-acciaio**  
Cylindrical head plug with embedded steel hexagon



Code	F	CH	P	L	Ø	Gr
E26418ZB	1/8	5	8,0	11,0	14,0	6,5
E26414ZB	1/4	6	12,0	15,0	18,0	15,0
E26438ZB	3/8	8	12,0	15,0	22,0	22,0
E26412ZB	1/2	10	14,0	18,0	26,0	39,6
E26434ZB	3/4	12	16,0	20,0	32,0	73,2
E2641ZB	1"	17	16,0	21,0	40,0	120,0

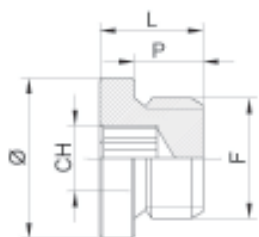

**Tappo femmina**  
Female plug



Code	F	CH	P	L	Gr
E26518NI	1/8	14	9,0	12,0	11,0
E26514NI	1/4	17	10,0	14,0	16,0
E26538NI	3/8	22	11,0	15,0	28,6
E26512NI	1/2	24	12,5	16,0	28,6

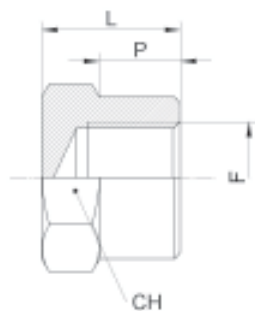

**Tappo testa cilindrica esagono incassato ottone con OR**  
 Cylindrical head plug with embedded brass hexagon with OR

Code	F	CH	P	L	Ø	Gr
E266M5NI	M5	2,5	4,0	6,0	8,0	1,5
E26618NI	1/8	5	6,0	9,0	14,0	4,6
E26614NI	1/4	6	8,0	11,5	18,0	8,4
E26638NI	3/8	8	9,0	12,5	22,0	16,8
E26612NI	1/2	10	10,0	14,5	26,0	28,0
E26634NI	3/4	12	15,5	20,0	32,0	79,0
E2661NI	1"	17	16,0	21,0	40,0	125,0

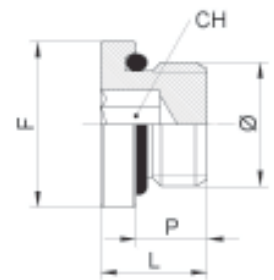

**Tappo maschio conico**  
 Male plug (taper)

Code	F	CH	L	Gr
E10018H5NI	1/8	5	5,0	2,0
E10018NI	1/8	5	8,0	3,0
E10014NI	1/4	6	10,0	7,5
E10038NI	3/8	8	11,0	13,0
E10012NI	1/2	10	13,0	22,0

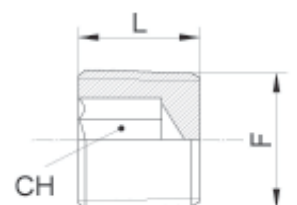

### Tappo maschio cilindrico

Male plug (parallel)



Code	F	CH	L	Gr
E20018H5NI	1/8	5	5,0	2,0
E20018NI	1/8	5	8,0	3,0
E20014NI	1/4	6	10,0	7,0
E20038NI	3/8	8	11,0	13,0
E20012NI	1/2	10	13,0	25,0
E20034NI	3/4	12	15,0	50,4

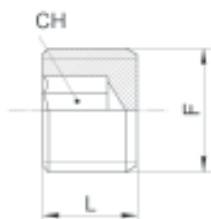

### Tappo maschio conico in acciaio

Steel male plug (taper)



Code	F	CH	L	Gr
E30018ZB	1/8	5	8,0	3,0
E30014ZB	1/4	7	10,0	7,0
E30038ZB	3/8	8	10,0	12,0
E30012ZB	1/2	10	10,0	18,5
E30034ZB	3/4	12	12,0	37,6
E3001ZB	1"	17	12,0	60,0

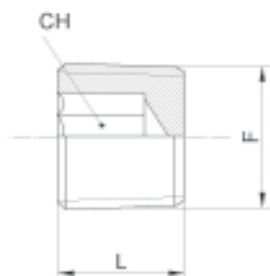

**Ghiera**  
Nut

Code	F	CH	L	Gr
DE12018NI	1/8	14	4,5	3,5
DE12014NI	1/4	17	5,0	5,0
DE12038NI	3/8	20	5,0	5,5
DE12012NI	1/2	24	6,0	8,0
DE1201NI	1"	41	6,0	8,0
DE120M101NI	M10x1	14	4,5	3,5
DE120M121NI	M12x1	17	4,5	5,0
DE120M141NI	M14x1	17	5,0	4,0
DE120M161NI	M16x1	19	5,0	5,0
DE120M201NI	M20x1	24	5,0	7,5
DE120M221NI	M22x1	25	5,0	6,5
DE120M1615NI	M16x1,5	22	5,0	6,0
DE120M1815NI	M18x1,5	22	6,0	6,0
DE120M2015NI	M20x1,5	24	6,0	8,0
DE120M2215NI	M22x1,5	27	7,0	10,0
DE120M2415NI	M24x1,5	30	7,0	12,0

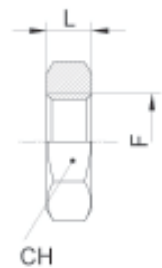

**Portagomma diritto doppio**  
Straight double rubber hose

Code	Ø	L	Gr
PG2554NI	4	29,5	4,0
PG2556NI	6	32,5	5,0
PG2557NI	7	32,5	7,0
PG2558NI	8	32,5	8,0
PG2559NI	9	46	11,0
PG25510NI	10	46	12,0



### Portagomma maschio cilindrico

Male hose adapter (parallel)

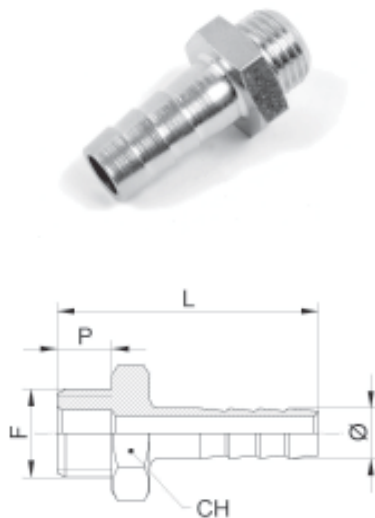

Code	F	Ø	CH	P	L	Gr
PG260M545NI	M5	4,5	8	4,0	22,5	7,0
PG260186NI	1/8	6	14	6,5	31,0	10,0
PG260187NI	1/8	7	14	6,5	31,0	10,5
PG260188NI	1/8	8	14	6,5	31,0	11,5
PG260189NI	1/8	9	14	6,5	31,0	12,5
PG2601810NI	1/8	10	14	6,5	31,0	15,0
PG260146NI	1/4	6	17	8,0	33,0	14,0
PG260147NI	1/4	7	17	8,0	33,0	15,0
PG260148NI	1/4	8	17	8,0	33,0	15,0
PG260149NI	1/4	9	17	8,0	35,0	17,0
PG2601410NI	1/4	10	17	8,0	35,0	18,0
PG2601412NI	1/4	12	17	8,0	35,0	19,0
PG2601414NI	1/4	14	17	8,0	35,0	29,5
PG260389NI	3/8	9	19	9,0	36,0	22,5
PG2603810NI	3/8	10	19	9,0	36,0	23,0
PG2603812NI	3/8	12	19	9,0	36,0	25,5
PG2603814NI	3/8	14	19	9,0	38,0	29,0
PG2603816NI	3/8	16	19	9,0	38,0	30,0
PG2603817NI	3/8	17	19	9,0	38,0	28,5
PG260128NI	1/2	8	24	10,0	42,0	32,5
PG2601210NI	1/2	10	24	10,0	42,0	31,5
PG2601212NI	1/2	12	24	10,0	42,0	35,0
PG2601214NI	1/2	14	24	10,0	42,0	39,5
PG2601216NI	1/2	16	24	10,0	42,0	42,0
PG2601217NI	1/2	17	24	10,0	42,0	43,5
PG2601220NI	1/2	20	24	10,0	42,0	43,5
PG2603420NI	3/4	20	30	12,0	47,0	86,5
PG2603425NI	3/4	25	30	12,0	53,0	87,5
PG260120NI	1"	20	27	12,0	50,5	98,0
PG260125NI	1"	25	28	13,0	61,0	98,4
PG260130NI	1"	30	32	12,0	60,0	108,4
PG26011430NI	1"1/4	30	38	15,0	64,0	155,2
PG26011440NI	1"1/4	40	45	15,5	77,0	214,6
PG26011240NI	1"1/2	40	45	16,0	77,0	240,0

### Prolunga cilindrica

Extension (parallel)



Code	F	CH	P	L	Gr
PRL1001816NI	1/8	14	7,0	23,0	14,5
PRL1001819NI	1/8	14	7,0	26,0	17,0
PRL1001822NI	1/8	14	7,0	29,0	19,5
PRL1001825NI	1/8	14	7,0	32,0	22,0
PRL1001836NI	1/8	14	7,0	43,0	31,0
PRL1001427NI	1/4	17	8,0	35,0	32,0
PRL1001443NI	1/4	17	8,0	51,0	54,0



**Portagomma maschio conico**

Male hose adapter (taper)

Code	F	Ø	CH	P	L	Gr
PG290186NI	1/8	6	12	8,0	32,5	11,0
PG290187NI	1/8	7	12	8,0	32,5	11,0
PG290188NI	1/8	8	12	8,0	32,5	11,5
PG290189NI	1/8	9	12	8,0	32,5	11,5
PG2901810NI	1/8	10	12	8,0	32,5	12,0
PG290146NI	1/4	6	14	11,0	36,0	14,0
PG290147NI	1/4	7	14	11,0	36,0	14,4
PG290148NI	1/4	8	14	11,0	36,0	14,5
PG290149NI	1/4	9	14	11,0	38,0	14,5
PG2901410NI	1/4	10	14	11,0	38,0	15,0
PG2901412NI	1/4	12	14	11,0	38,0	15,0
PG290389NI	3/8	9	17	11,5	38,5	22,0
PG2903810NI	3/8	10	17	11,5	38,5	23,0
PG2903812NI	3/8	12	17	11,5	38,5	24,0
PG2903814NI	3/8	14	17	11,5	40,5	24,8
PG2903816NI	3/8	16	17	11,5	40,5	25,0
PG2903817NI	3/8	17	19	11,5	40,5	25,0
PG2901210NI	1/2	10	22	14,0	46,0	41,0
PG2901212NI	1/2	12	22	14,0	46,0	42,0
PG2901214NI	1/2	14	22	14,0	46,0	43,0
PG2901216NI	1/2	16	22	14,0	46,0	44,0
PG2901217NI	1/2	17	22	14,0	46,0	44,0
PG2901220NI	1/2	20	22	14,0	46,0	46,0
PG2903416NI	3/4	16	27	16,0	45,0	60,0
PG2903418NI	3/4	18	27	16,0	47,0	64,0
PG2903420NI	3/4	20	27	16,0	51,0	72,0
PG2903425NI	3/4	25	27	16,0	57,0	72,0
PG290125NI	1"	25	34	19,0	60,0	103,0

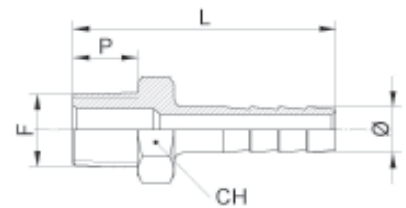

**Passaparete**

Bulkhead connector

Code	F	F1	Cmax	P	E	CH	CH1	Gr
RAE100M5NI	M5	M10x1	6,5	10,5	3,5	14	14	11,8
RAE10018NI	1/8	M16x1,5	10,0	14,0	4,0	19	22	29,0
RAE10014NI	1/4	M20x1,5	16,0	21,0	4,0	24	27	50,0
RAE10038NI	3/8	M26x1,5	15,0	21,0	5,0	30	32	72,5
RAE10012NI	1/2	M28x1,5	21,0	27,0	6,0	32	36	86,0

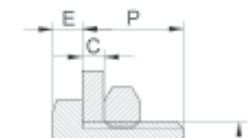

## Portagomma femmina cilindrico

Female hose adapter

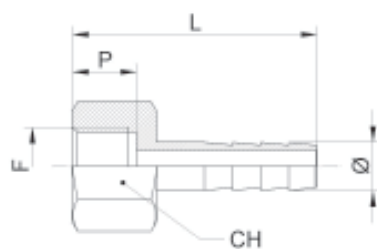

Code	F	Ø	CH	P	L	Gr
PG250186NI	1/8	6	14	8,0	30,5	12,5
PG250187NI	1/8	7	14	8,0	30,5	13,5
PG250188NI	1/8	8	14	8,0	30,5	13,4
PG250189NI	1/8	9	14	8,0	30,5	14,8
PG250146NI	1/4	6	17	11,0	33,5	19,4
PG250147NI	1/4	7	17	11,0	33,5	20,0
PG250148NI	1/4	8	17	11,0	33,5	20,8
PG250149NI	1/4	9	17	11,0	35,5	21,0
PG2501410NI	1/4	10	17	11,0	35,5	24,2
PG2501412NI	1/4	12	17	11,0	35,5	25,4
PG250389NI	3/8	9	20	12,0	36,5	25,0
PG2503810NI	3/8	10	20	12,0	36,5	28,8
PG2503812NI	3/8	12	20	12,0	36,5	29,0
PG2503814NI	3/8	14	20	12,0	38,5	34,0
PG2503817NI	3/8	17	20	12,0	38,5	35,4
PG2501210NI	1/2	10	24	14,0	41,5	42,2
PG2501212NI	1/2	12	24	14,0	41,5	42,5
PG2501213NI	1/2	13	24	14,0	41,5	44,8
PG2501214NI	1/2	14	24	14,0	41,5	45,5
PG2501217NI	1/2	17	24	14,0	41,5	48,0
PG2501220NI	1/2	20	24	14,0	41,5	51,4

## Raccordo a L maschio con portagomma

Elbow male hose adapter (taper)

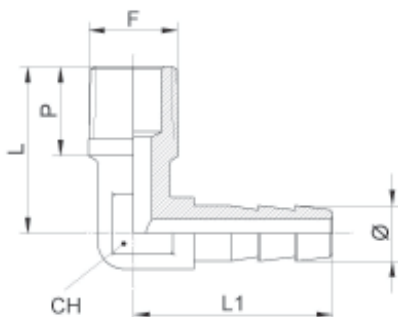

Code	F	Ø	CH	P	L	L1	Gr
PG258186NI	1/8	6	9	9,0	18,0	21,5	11,0
PG258187NI	1/8	7	10	9,0	19,0	22,5	14,0
PG258188NI	1/8	8	10	8,0	19,0	22,5	14,5
PG258189NI	1/8	9	11	8,0	20,0	24,0	16,0
PG2581810NI	1/8	10	13	8,0	19,0	25,0	23,0
PG258146NI	1/4	6	10	11,0	22,0	22,5	19,0
PG258147NI	1/4	7	10	11,0	22,0	22,5	18,6
PG258148NI	1/4	8	10	11,0	22,0	22,5	19,5
PG258149NI	1/4	9	11	11,0	22,0	24,0	20,5
PG2581410NI	1/4	10	14	11,0	25,0	27,0	28,5
PG2581412NI	1/4	12	14	11,0	25,0	27,0	28,6

**Portagomma maschio cilindrico con OR**  
Male hose adapter (parallel) with OR

Code	F	Ø	CH	P	L	Gr
PG265M545NI	M5	4,5	8	4,5	23,0	7,0
PG265186NI	1/8	6	14	6,5	30,0	10,0
PG265187NI	1/8	7	14	6,5	30,0	10,0
PG265188NI	1/8	8	14	6,5	30,0	10,0
PG265189NI	1/8	9	14	6,5	30,0	10,0
PG2651810NI	1/8	10	14	6,5	31,0	16,6
PG265146NI	1/4	6	17	8,0	32,0	13,0
PG265147NI	1/4	7	17	8,0	32,0	15,0
PG265148NI	1/4	8	17	8,0	32,0	17,0
PG265149NI	1/4	9	17	8,0	32,0	15,0
PG2651410NI	1/4	10	17	8,0	33,0	19,5
PG2651412NI	1/4	12	17	8,0	33,0	23,0
PG265389NI	3/8	9	20	9,0	33,0	23,0
PG2653810NI	3/8	10	20	9,0	34,0	23,0
PG2653812NI	3/8	12	20	9,0	34,0	23,0
PG2653814NI	3/8	14	20	9,0	38,0	23,0
PG2653816NI	3/8	16	20	9,0	38,0	38,5
PG2653817NI	3/8	17	20	9,0	38,0	38,5
PG265128NI	1/2	8	25	10,0	36,0	40,5
PG2651210NI	1/2	10	25	10,0	36,0	42,5
PG2651212NI	1/2	12	25	10,0	36,0	44,5
PG2651214NI	1/2	14	25	10,0	40,0	48,5
PG2651216NI	1/2	16	25	10,0	40,0	50,0
PG2651217NI	1/2	17	25	10,0	40,0	43,5
PG2651220NI	1/2	20	25	10,0	40,0	68,5
PG2653420NI	3/4	20	32	12,0	43,0	86,0
PG2653425NI	3/4	25	32	12,0	49,0	85,5

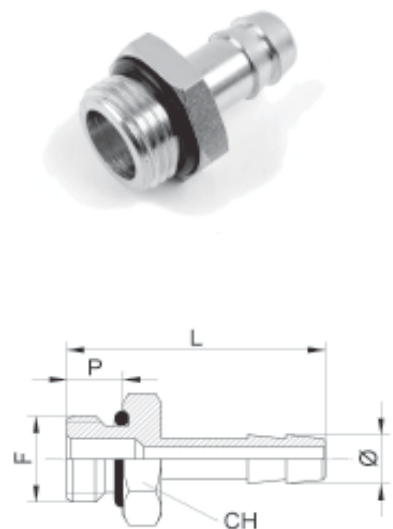

**Raccordo a L femmina con portagomma**  
Elbow female hose adapter

Code	F	Ø	CH	P	L	L1	Gr
PG259186NI	1/8	6	10	8,0	22,0	22,5	19,4
PG259187NI	1/8	7	10	8,0	22,0	22,5	19,5
PG259188NI	1/8	8	10	8,0	22,0	22,5	19,5
PG259189NI	1/8	9	11	8,0	22,0	24,0	21,4
PG2591810NI	1/8	10	13	8,0	19,0	25,0	25,4
PG259146NI	1/4	6	11	9,0	23,5	25,0	23,8
PG259147NI	1/4	7	11	9,0	23,5	25,0	24,0
PG259148NI	1/4	8	11	9,0	23,5	25,0	25,0
PG259149NI	1/4	9	11	9,0	23,5	25,0	24,5
PG2591410NI	1/4	10	14	9,0	27,5	27,0	38,0
PG2591412NI	1/4	12	14	9,0	27,5	27,5	37,6

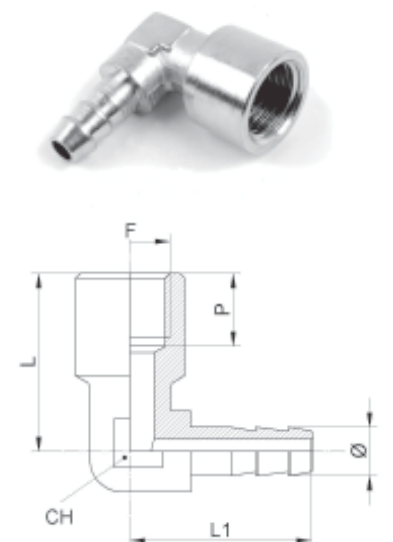

### Vite cava singola corta

Single short banjo screw



Code	F	CH	P	L	Gr
VC1631M5NI	M5	8	4,0	18,0	3,0
VC163118NI	1/8	14	6,0	28,0	14,0
VC163114NI	1/4	17	8,0	30,0	24,0
VC163138NI	3/8	19	8,5	30,5	35,0
VC163112NI	1/2	24	10,0	32,0	49,0

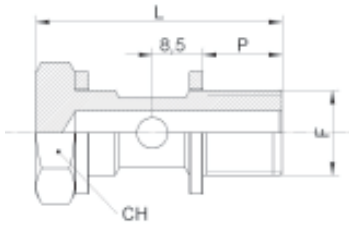

### Vite cava doppia corta

Double short banjo screw



Code	F	CH	P	L	Gr
VC163218NI	1/8	14	6,0	44,0	19,5
VC163214NI	1/4	17	8,0	46,0	33,4
VC163238NI	3/8	19	8,5	47,0	52,0
VC163212NI	1/2	24	10,0	48,0	78,0

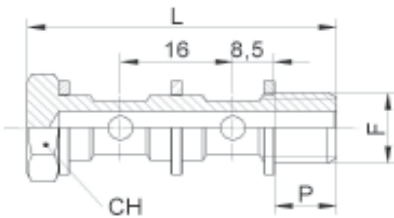

**Vite cava tripla corta**

Triple short banjo screw

Code	F	CH	P	L	Gr
VC163318NI	1/8	14	6,0	59,0	23,0
VC163314NI	1/4	17	8,0	61,5	42,0

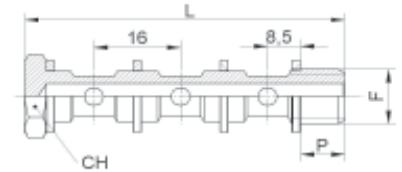

**Vite cava singola lunga**

Single long banjo screw

Code	F	CH	P	L	Gr
VC165114NI	1/4	17	10,0	33,0	29,0

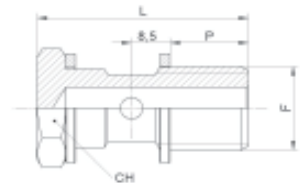

**Vite cava doppia lunga**

Double long banjo screw

Code	F	CH	P	L	Gr
VC165214NI	1/4	17	11,0	51,5	34,0

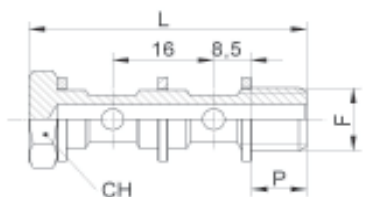

**Note: Qualsiasi tipo di vite cava è fornita, di serie, senza rondella**

Note: Every kind of pit screw can be supplied in mass production without washer

### Rondella in alluminio

Aluminium washer



Code		Ø	Ø1	H	Gr
RAL100M5GR	M5	5	9,0	1,0	0,0
RAL10018GR	1/8	10	14,0	1,5	0,2
RAL10014GR	1/4	13,5	18,0	1,5	0,4
RAL10038GR	3/8	17	22,0	1,5	0,6
RAL10012GR	1/2	21,5	27,0	1,5	0,8
RAL10034GR	3/4	27	33,0	1,5	1,2

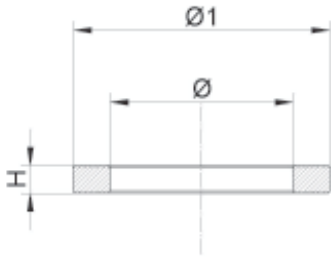

### Rondella in nylon

Nylon washer



Code		Ø	Ø1	H	Gr
RNY200M5	M5	5	8,0	1,0	0,1
RNY20018	1/8	10	14,0	1,6	0,2
RNY20014	1/4	13	17,5	1,6	0,2
RNY20038	3/8	16,5	21,5	1,8	0,2
RNY20012	1/2	21	26,5	2,0	0,2
RNY20034	3/4	26,5	32,0	2,0	0,2
RNY2001	1"	33,6	41,0	1,5	0,3
RNY200114	1"1/4	42,5	54,0	1,5	0,4
RNY200112	1"1/2	47,5	60,0	1,5	0,4
RNY2002	2"	59,5	72,0	1,5	0,5

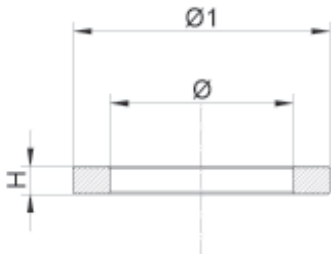

### Rondella dentellata in nylon

Nylon notched washer

Code		Ø	Ø1	H	Gr
RNYD300M5	M5	5	8,0	1,0	0,1
RNYD300M6	M6	6	9,0	1,5	0,1
RNYD30018	1/8	10	14,0	1,6	0,1
RNYD30014	1/4	13	17,5	1,6	0,1
RNYD30038	3/8	17	21,5	1,8	0,2
RNYD30012	1/2	21	26,5	2,0	0,4
RNYD30034	3/4	27	32,0	2,0	0,6
RNYD3001	1"	33	41,0	2,5	0,7

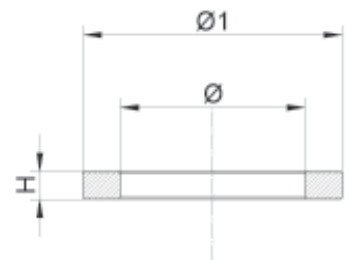

### Valvola scarico rapido

Quick relief valve

Code	F	P	L	L1	CH	CH1	E
VSCR100M5NI	M5	4	24,8	15,6	10	10	10,5
VSCR10018NI	1/8	8	42	28	14	14	19,5
VSCR10014NI	1/4	11	53	34,5	19	19	25
VSCR10038NI	3/8	12	58	36	21	21	26
VSCR10012NI	1/2	14	71	44	26	26	35
VSCR10034NI	3/4	18	86	52	32	32	38,5
VSCR1001NI	1"	19	94	56	38	38	42

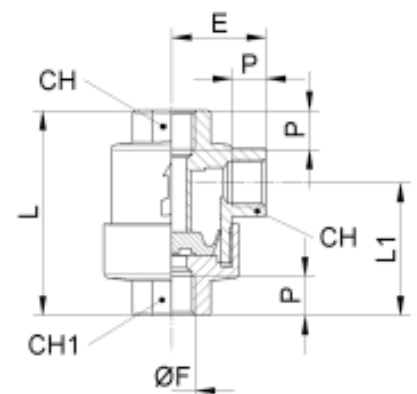

### Tappo indicatore livello visivo (alluminio)

Visual level indicator (aluminium)

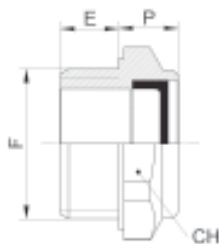

Code	F	E	P	CH	Gr
TIL68014GR	1/4	9	8,0	17	6,2
TIL68038GR	3/8	10	9,0	22	10,6
TIL68012GR	1/2	11	9,0	27	12,4
TIL68034GR	3/4	11	11,0	32	20,0
TIL6801GR	1"	12	10,0	40	31,8

### Raccordo a croce in alluminio

Aluminium tee cross



Code	F	Ø	P	L	D	B	Gr
B30318GR	1/8	4,5	7,0	25,0	15,0	17,0	18,0
B30314GR	1/4	5,5	11,0	40,0	20,0	26,0	64,0
B30338GR	3/8	5,5	12,0	50,0	25,0	34,0	125,0
B30312GR	1/2	5,5	12,0	50,0	30,0	34,0	138,0
B30334GR	3/4	5,5	14,0	60,0	35,0	45,0	209,6
B30318ANN	1/8	4,5	7,0	25,0	15,0	17,0	18,0
B30314ANN	1/4	5,5	11,0	40,0	20,0	26,0	64,0
B30338ANN	3/8	5,5	12,0	50,0	25,0	34,0	125,0
B30312ANN	1/2	5,5	12,0	50,0	30,0	34,0	138,0

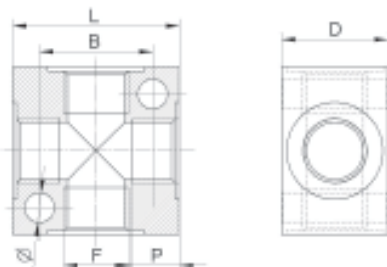



### Ripartitore lineare

Linear manifold

Code	A	B	C	D	L	F	G	Ø	Gr.
RIL2E182UM5	1/8	M5	25	16,0	45	15,0	3,5	4,5	78,0
RIL2E183UM5	1/8	M5	25	16,0	60	15,0	3,5	4,5	128,0
RIL2E184UM5	1/8	M5	25	16,0	75	15,0	3,5	4,5	174,0
RIL2E185UM5	1/8	M5	25	16,0	90	15,0	3,5	4,5	222,0
RIL2E186UM5	1/8	M5	25	16,0	105	15,0	3,5	4,5	268,0
RIL2E142U18	1/4	1/8	30	20,0	54	18,0	4,5	4,5	100,0
RIL2E143U18	1/4	1/8	30	20,0	72	18,0	4,5	4,5	150,0
RIL2E144U18	1/4	1/8	30	20,0	90	18,0	4,5	4,5	205,0
RIL2E145U18	1/4	1/8	30	20,0	108	18,0	4,5	4,5	245,0
RIL2E146U18	1/4	1/8	30	20,0	126	18,0	4,5	4,5	307,0
RIL2E382U14	3/8	1/4	40	25,0	68	24,0	6,0	5,5	140,4
RIL2E383U14	3/8	1/4	40	25,0	92	24,0	6,0	5,5	190,2
RIL2E384U14	3/8	1/4	40	25,0	116	24,0	6,0	5,5	243,6
RIL2E385U14	3/8	1/4	40	25,0	140	24,0	6,0	5,5	286,6
RIL2E386U14	3/8	1/4	40	25,0	164	24,0	6,0	5,5	344,2

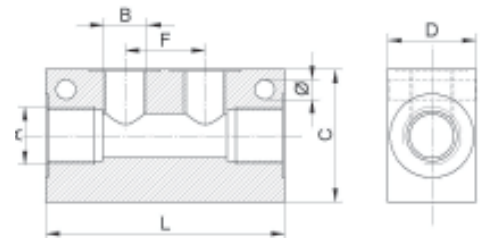

### Ripartitore contrapposto

Opposite manifold

Code	A	B	C	D	L	F	G	Ø	Gr.
RIC2E182UM5	1/8	M5	25	16,0	45	15,0	3,5	4,5	70,0
RIC2E183UM5	1/8	M5	25	16,0	60	15,0	3,5	4,5	120,0
RIC2E184UM5	1/8	M5	25	16,0	75	15,0	3,5	4,5	165,0
RIC2E185UM5	1/8	M5	25	16,0	90	15,0	3,5	4,5	210,0
RIC2E186UM5	1/8	M5	25	16,0	105	15,0	3,5	4,5	255,0
RIC2E142U18	1/4	1/8	30	20,0	54	18,0	4,5	4,5	90,0
RIC2E143U18	1/4	1/8	30	20,0	72	18,0	4,5	4,5	140,0
RIC2E144U18	1/4	1/8	30	20,0	90	18,0	4,5	4,5	190,0
RIC2E145U18	1/4	1/8	30	20,0	108	18,0	4,5	4,5	230,0
RIC2E146U18	1/4	1/8	30	20,0	126	18,0	4,5	4,5	290,0
RIC2E382U14	3/8	1/4	40	25,0	68	24,0	6,0	5,5	140,4
RIC2E383U14	3/8	1/4	40	25,0	92	24,0	6,0	5,5	190,2
RIC2E384U14	3/8	1/4	40	25,0	116	24,0	6,0	5,5	243,6
RIC2E385U14	3/8	1/4	40	25,0	140	24,0	6,0	5,5	286,6
RIC2E386U14	3/8	1/4	40	25,0	164	24,0	6,0	5,5	344,2

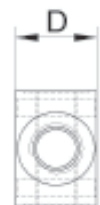

### Ripartitore lineare lungo

Long linear manifold



Code	A	B	C	D	L	F	G	Ø	Gr.
RILSL2E142U18	1/4	1/8	30	20,0	60	30,0	4,5	5,5	77,0
RILSL2E143U18	1/4	1/8	30	20,0	90	30,0	4,5	5,5	118,0
RILSL2E144U18	1/4	1/8	30	20,0	120	30,0	4,5	5,5	159,0
RILSL2E145U18	1/4	1/8	30	20,0	150	30,0	4,5	5,5	200,0
RILSL2E146U18	1/4	1/8	30	20,0	180	30,0	4,5	5,5	242,0
RILSL2E382U18	3/8	1/8	40	20,0	66	30,0	4,5	5,5	137,0
RILSL2E383U18	3/8	1/8	30	25,0	96	30,0	4,5	5,5	154,0
RILSL2E384U18	3/8	1/8	30	25,0	126	30,0	4,5	5,5	206,0
RILSL2E385U18	3/8	1/8	30	25,0	156	30,0	4,5	5,5	257,0
RILSL2E386U18	3/8	1/8	30	25,0	186	30,0	4,5	5,5	307,0
RILSL2E382U14	3/8	1/4	40	20,0	72	36,0	6,0	6,5	107,0
RILSL2E383U14	3/8	1/4	30	25,0	108	36,0	6,0	6,5	168,0
RILSL2E384U14	3/8	1/4	30	25,0	144	36,0	6,0	6,5	224,0
RILSL2E385U14	3/8	1/4	30	25,0	180	36,0	6,0	6,5	287,0
RILSL2E386U14	3/8	1/4	30	25,0	216	36,0	6,0	6,5	347,0

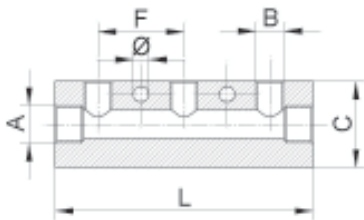

### Ripartitore contrapposto lungo

Long opposite manifold



Code	A	B	C	D	L	F	G	Ø	Gr.
RICSL2E142U18	1/4	1/8	30	20,0	60	30,0	4,5	5,5	73,0
RICSL2E143U18	1/4	1/8	30	20,0	90	30,0	4,5	5,5	110,0
RICSL2E144U18	1/4	1/8	30	20,0	120	30,0	4,5	5,5	152,0
RICSL2E145U18	1/4	1/8	30	20,0	150	30,0	4,5	5,5	190,0
RICSL2E382U18	3/8	1/8	40	20,0	66	30,0	6,0	5,5	137,0
RICSL2E383U18	3/8	1/8	40	25,0	96	30,0	4,5	5,5	202,0
RICSL2E384U18	3/8	1/8	40	25,0	126	30,0	4,5	5,5	266,0
RICSL2E385U18	3/8	1/8	40	25,0	156	30,0	4,5	5,5	331,0
RICSL2E382U14	3/8	1/4	40	20,0	72	36,0	6,0	6,5	99,0
RICSL2E383U14	3/8	1/4	40	25,0	108	36,0	6,0	6,5	215,0
RICSL2E384U14	3/8	1/4	40	25,0	144	36,0	6,0	6,5	290,0
RICSL2E385U14	3/8	1/4	40	25,0	180	36,0	6,0	6,5	365,0

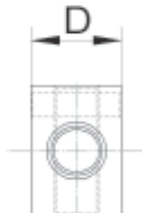

PISTOLA PER ARIA  
COMPRESSA

CODICE	COLORE
IAG-BL	BLU
IAG-R	ROSSO



TAGLIATUBI

CODICE	COLORE
IAT-BL	BLU

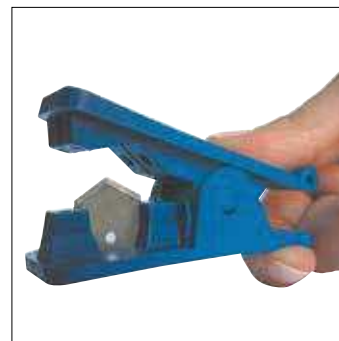

PINZA TAGLIATUBO

CODICE	Ø TUBO
PTG-12	2-12
PTG-25	12-25



LAME DI RICAMBIO  
TAGLIATUBO

CODICE	Ø TUBO
LRTG-12	2-12
LRTG-25	12-25



TEFLON

CODICE
TEFLON



FRENA FILETTI

CODICE
52A43



TEFLON

CODICE
56A01



FRENA FILETTI

CODICE
56A41



